

# Bootzeil

## ShapeX Motor Cruisers

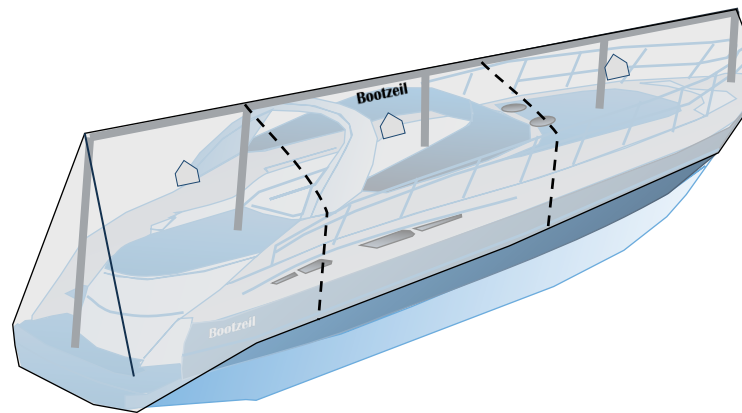

# Installation instruction ShapeX Motor Cruiser

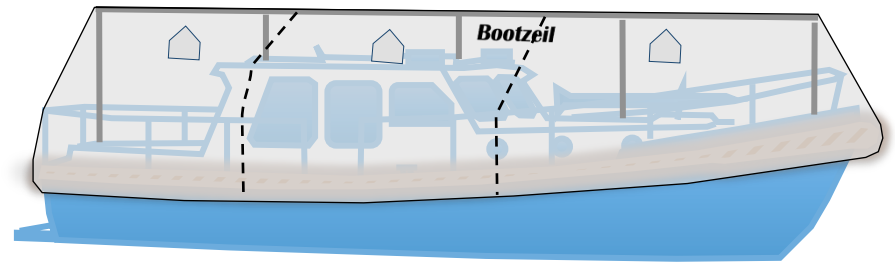
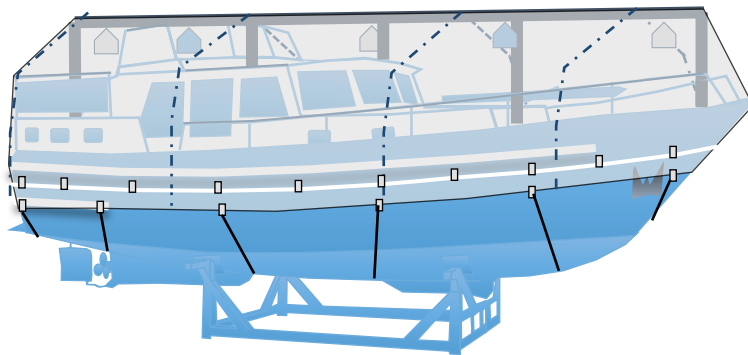
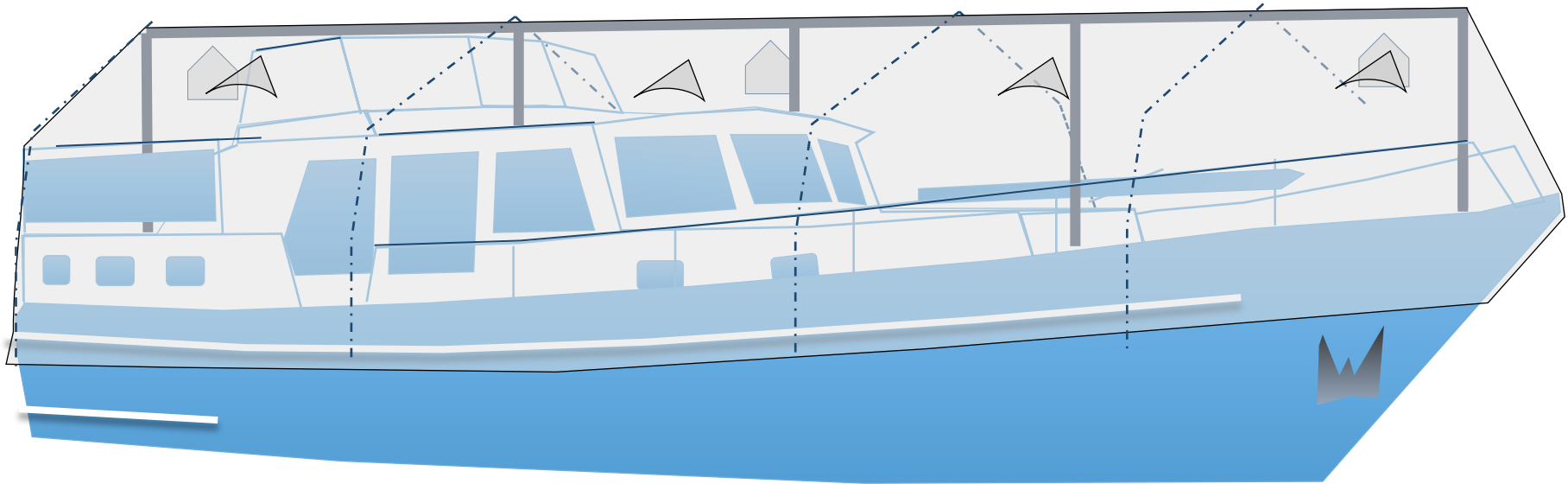

## Instruction video's:

To ensure you are well prepared, we advise you to watch the installation videos on our website.

**[www.Bootzeil.nl/  
instructie-handleidingen-  
download/](http://www.Bootzeil.nl/instructie-handleidingen-download/)**

## Installation services:

The installation can also be done by our experienced installers. For more info, feel free to give us a call

**+31 (0)23 – 521 96 92**

or send us an email  
**[info@bootzeil.nl](mailto:info@bootzeil.nl)**

## Winter care Service:

- Mounting and dismounting once a year
- Interim check-up
- Maintenance once a year
- Storage during summer

\* Ask for the conditions

# Our pride

Currently, Bootzeil is the most innovative producer of boat covers. With pride we present to you our “ShapeX” boat covers. These wonderful products enable you to create your own boat cover. Thanks to our practical components, special welding glue and high quality “Endurance+” fabric, you can easily determine the location of the components and tailor the boat cover to your special needs. The entire Bootzeil ShapeX team and its partners: Griffon, Heytex and 3M Venture tape, would like to wish you all the best in making your own and special boat cover.









# Disclaimer

- Read the entire manual before starting, to get an understanding of the entire process.
- The color of the welding glue will change when it comes in contact with UV-light.
- The welding glue has to dry for at least 24hours before tension can be put on the part. When temperatures are below 18degrees Celsius, the welding-glue will be hardened in 1hour.
- When tape is being removed, it may leave residues behind.
- To prevent mistakes, follow each step with care in the correct order (don't skip any steps and read all of the warnings and tips).
- We provide you with all the parts needed to make one boat cover. Made a mistake during the installation process? Don't worry, all the parts can be ordered separately (try to prevent this for your own conveni).
- The boat cover can withstand the weight of snow, we do advice you to remove heavy amounts of snow.
- A special frame is needed to complete this installation. Bootzeil has a special "Hurricane" frame which can be used however, a self-made frame can be used as well.
- Feel free to give us a call **+31 (0) 23 521 9692** or visit our site for help [https://www.bootzeil.nl/contact-english.](https://www.bootzeil.nl/contact-english)

# Table of contents

List of symbols	6
Included in the set	7
Instructions: Welding-glue	8
Instructions: Tightening the loops	10
Segments boat cover	11
Laying segments on the boat	12
Positioning the cover	13
Determining backside	14
Tailoring the backside, Type A & Type B	15
Tailoring the backside (Davits)	19
Tightening the loops	21
Tailoring the frontside	22
Placing mooring slots	25
Tailoring skirt	26
Strengthen the boat cover	27
Spanfix, Boat remains in the water	28
Option: Spanfix, Boat for storage on land	29
Mounting the cover after 1st installation	30
Tips	31
FAQ	32

# List of symbols

	All actions should be performed on the boat
	All actions should be performed on the side
	Indicates important actions to prevent mistakes
	Additional information
	A handy tip from our experienced installers
	Read the Welding glue instructions with care. Gluing will be necessary.

## Included in the set

### Additional requirements

- A frame (Bootzeil recommends the 'Hurricane frame')
- Calm weather. Not too windy or rainy
- A lighter
- A tapeline
- Cheap canvas 4x4 meters, or a clean surface (not always necessary)
- First installation can be done by one person, but it's easier with 2 people

### Preperation

- First, read the entire manual
- Check the contents of the package

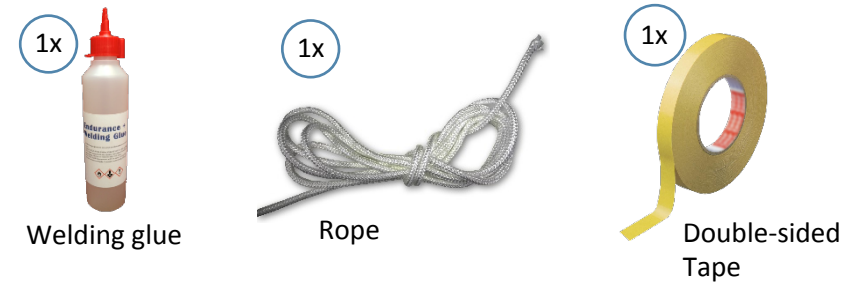
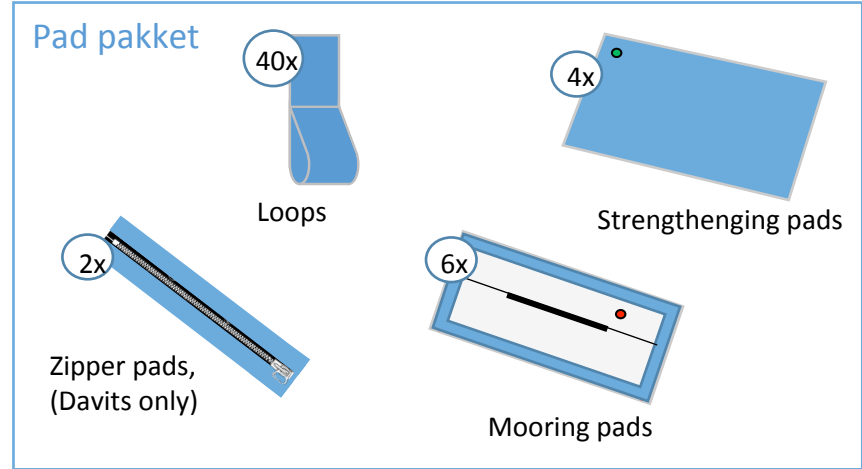
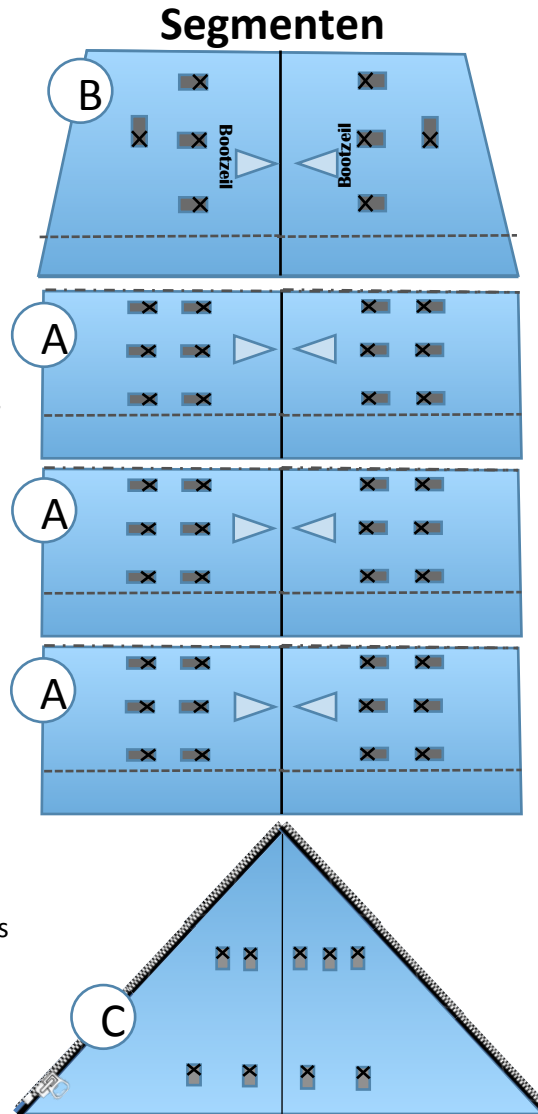

**TIP** Keep the remains of the ShapeX set and the fabric, as they may be of use for repairs.

The amount of segments can differ per length of the boat



# Instructions: Welding glue

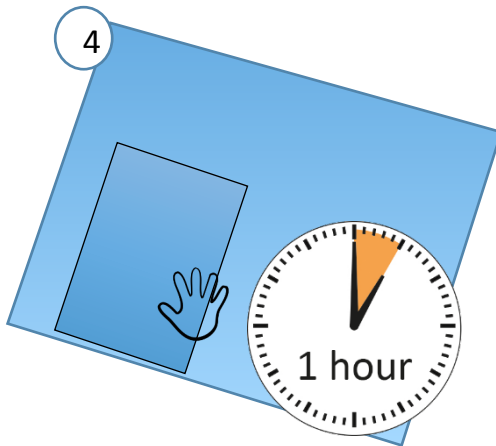
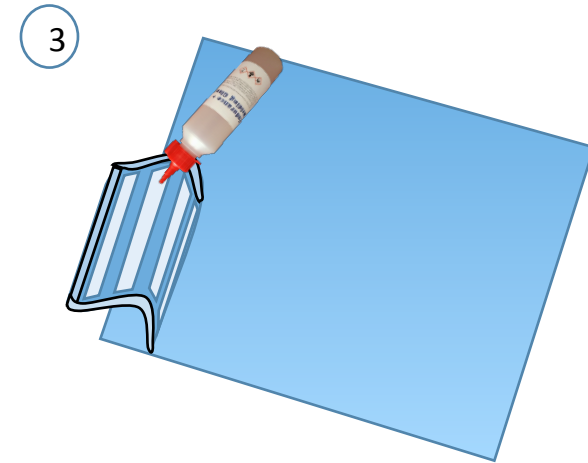
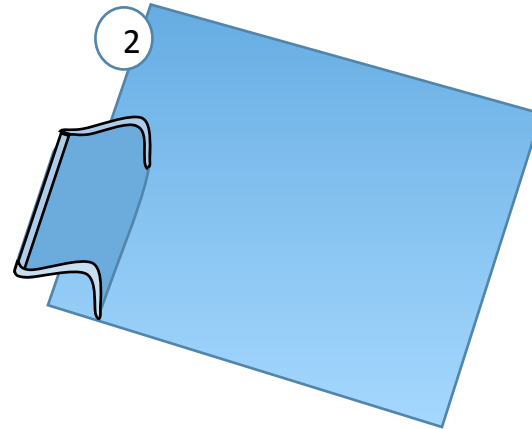
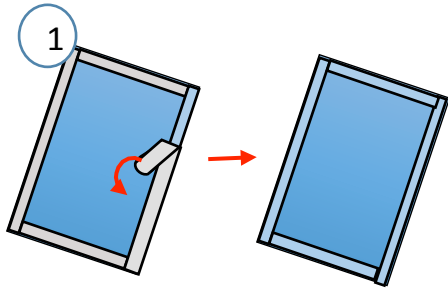

Exposure to UV light will cause discolorization staining on the fabric. Please ensure you don't use too much glue or spill any on the fabric. If this happens, try to wipe it off with a towel asap!

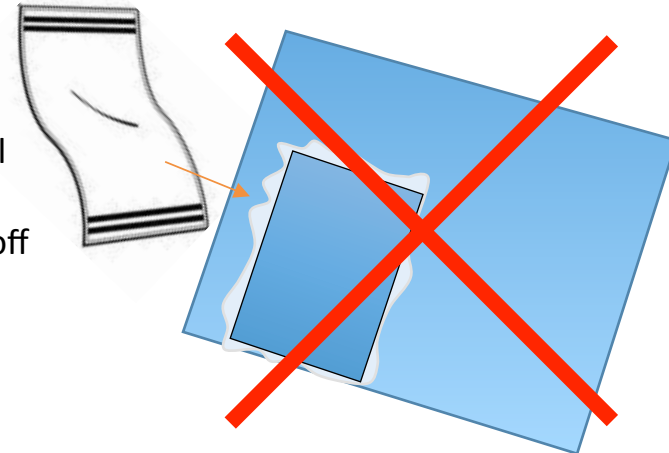

To prevent glue residues, you can place masking tape around the location of the pad. Any excess glue will spill on the tape, leaving your boat cover in perfect condition.





# Instructions: Welding glue

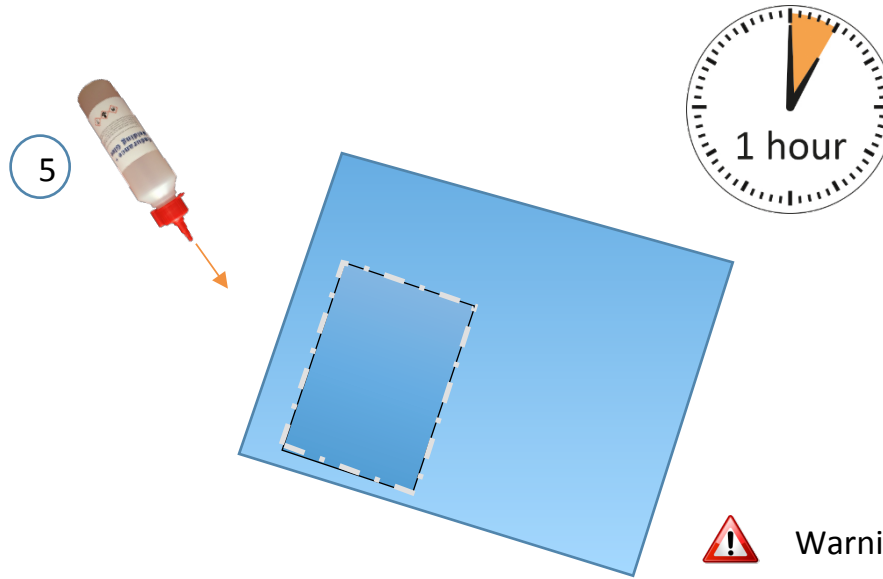

Warning! Prevent excessive amounts of glue. This will effect the appearance of the boat cover.



If you want to get a feel on how the glue works, try to use some on the inside of the boat cover.



### Additional information about the glue

H225 - Licht ontvlambare vloeistof en damp.

H319 - Veroorzaakt ernstige oogirritatie.

H335 - Kan irritatie van de luchtwegen veroorzaken.

### Additional hazardous information

EUH019 - May form explosive peroxides.

### Precautions

P210 - Keep away from heat, hot surfaces, sparks, open flames and other ignition sources. No smoking.

P261 - Avoid breathing dust/fumes/gas/mist/vapours/spray.

P305+P351+P338 - IF IN EYES: Rinse cautiously with water for several minutes; remove contact lenses if present and easy to do. Continue rinsing.



# Instructions: Tightening the loops

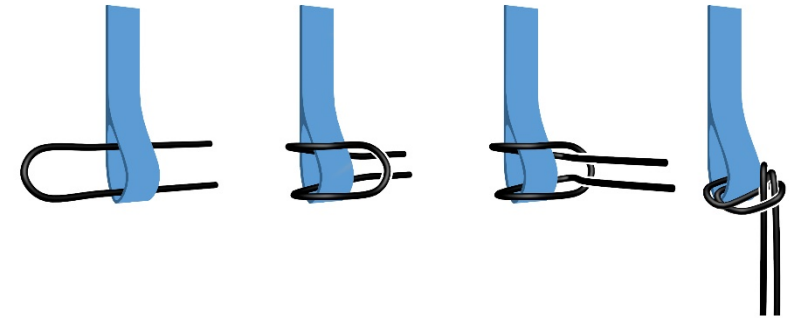
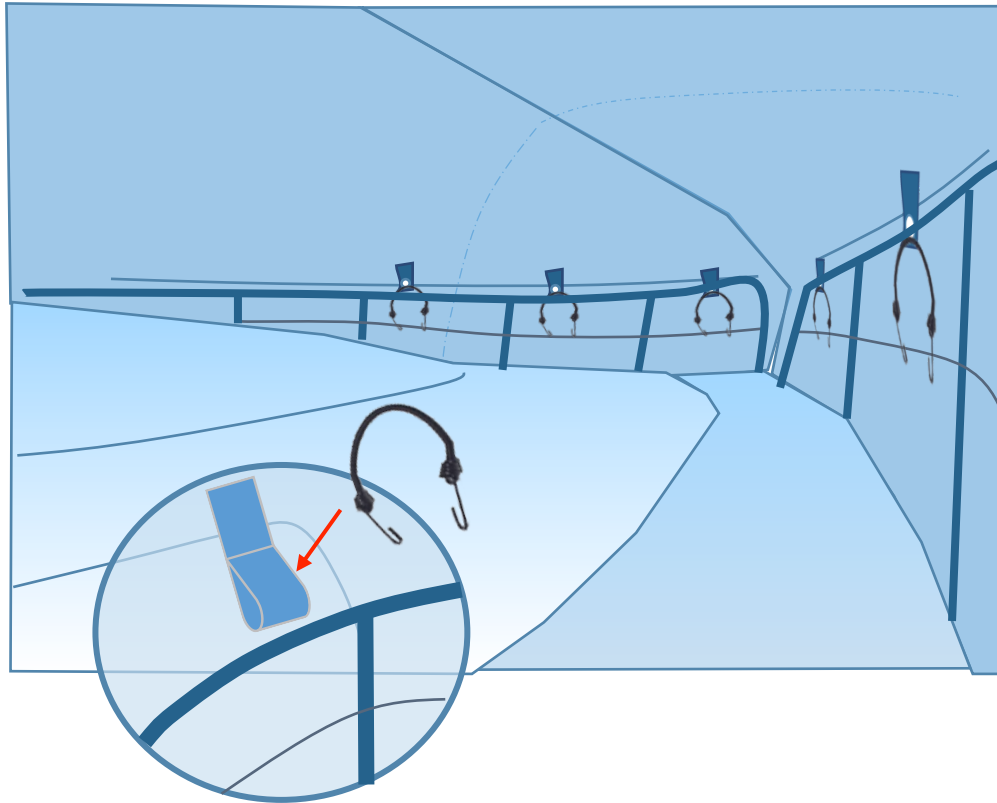

Start at the front of the boat when placing the absorption cords. Place one left, then right and work your way to the back of the boat. This way, the cover will remain in perfect position of the boat and not pull to one side.

 Make sure that you pull in the direction of the loops when applying tension to the cords. Don't be scared to put too much tension on them.



Make sure the hooks of the cords are not facing the fabric. They can damage the fabric during high winds.



When the loops are not in an ideal position for your boat, simply weld / glue new ones at the desired position on the inside of the cover. Be sure to let the glue dry for 1 hour before applying tension.

# Segments boat cover

## Segments

The boat cover exist of several segments, A, B & C. The amount of (A) segments depends on the length of the boat.

## Loops

Enable you to secure the cover onto the boat.

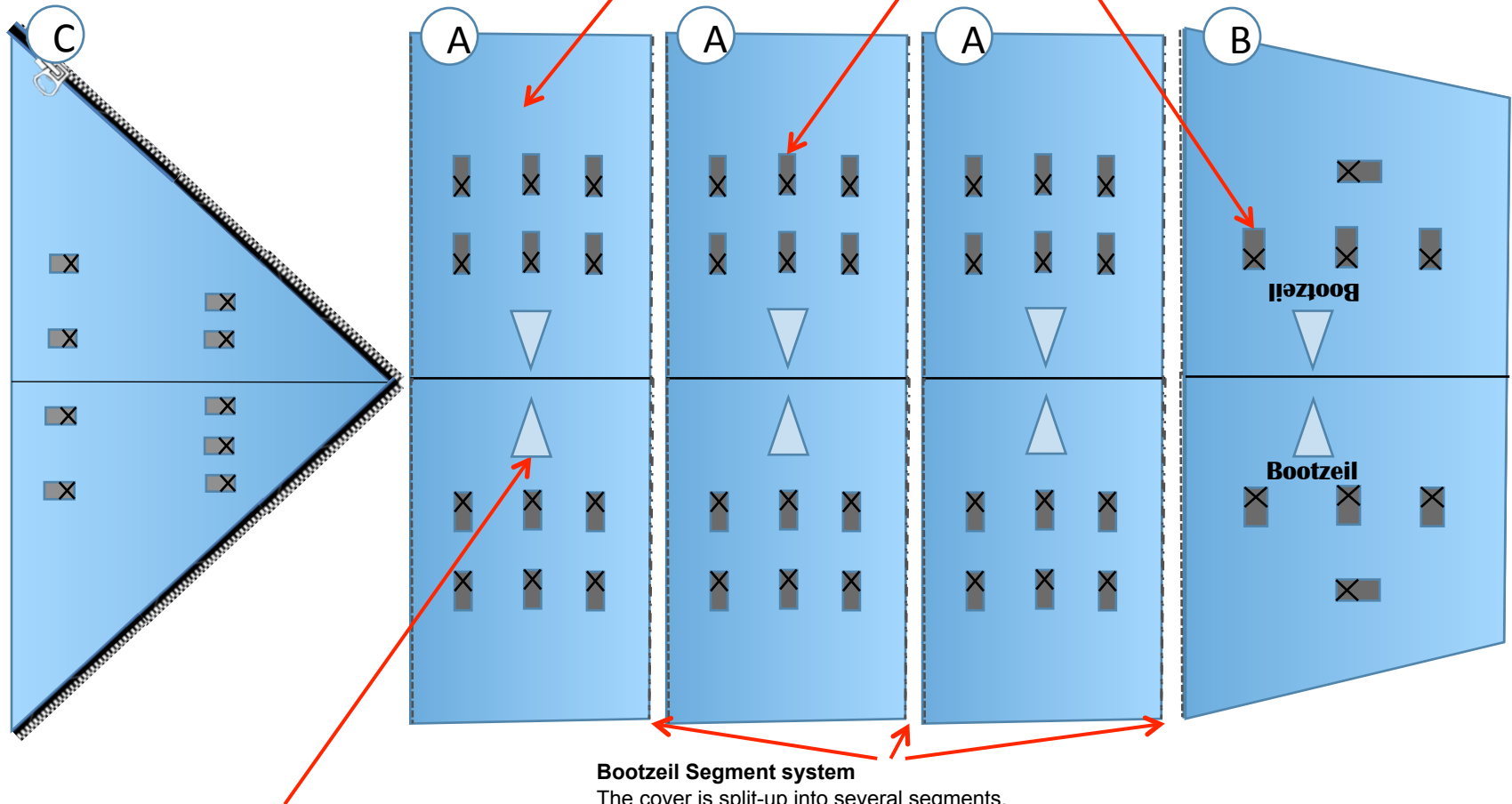

## Bootzeil Segment system

The cover is split-up into several segments. Each segment can be connected with the use of YKK zippers.

**Ventilation:** Sufficient ventilation slots

## Laying segments on the boat



When using the Bootzeil "Hurricane" frame, please consult the manual for its installation.

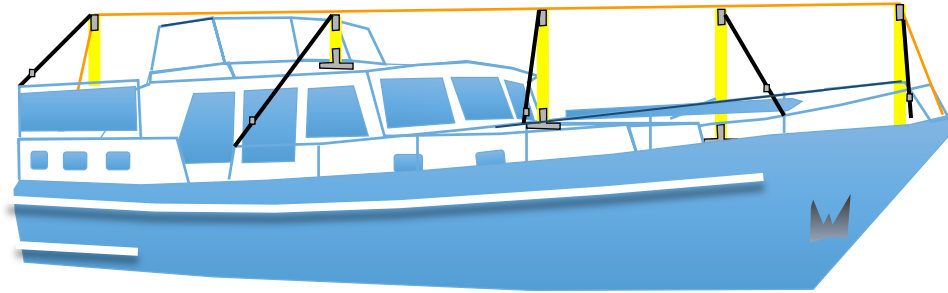

## Placing the cover

**i** Start with segment (B) and connect it with segment (A), working your way to the back of the boat.

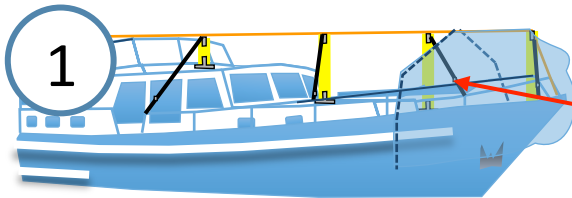

Connect the segments using the zippers

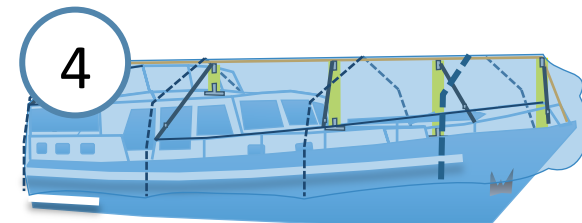
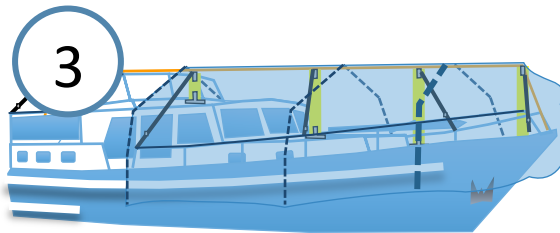
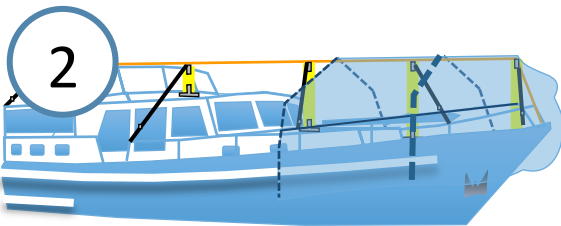

Ensure that segment (C) aligns perfectly with the pole of the frame.

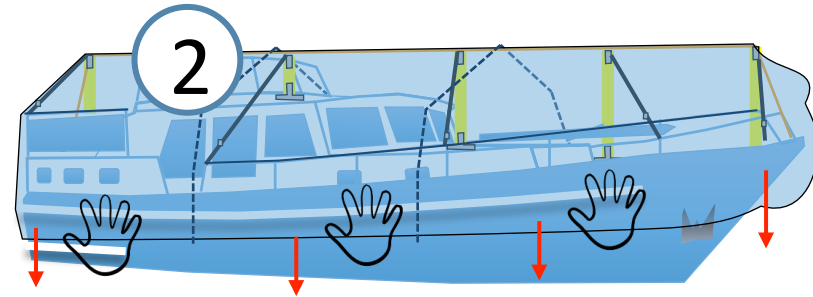
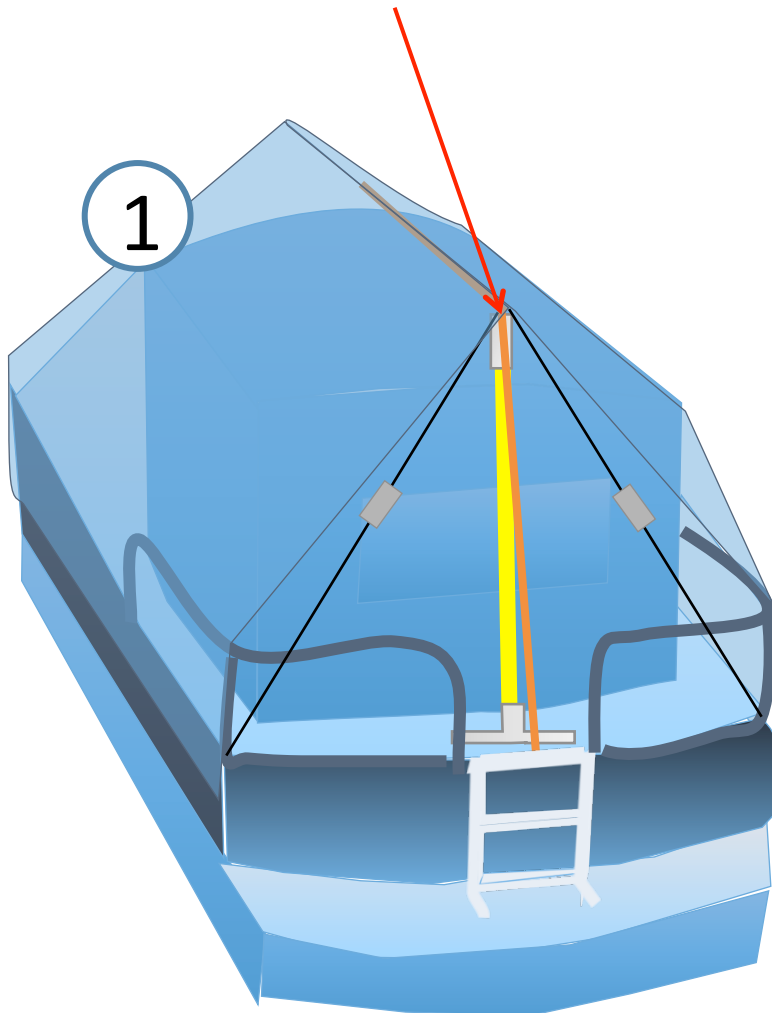

Pull the skirt down, but keep the cover in the middle of the boat.

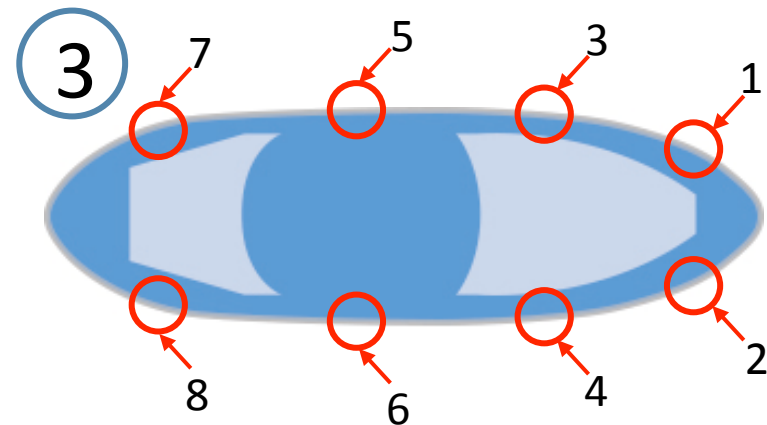

Secure the cover to the boat using 8 shock-absorption cords

 **See page 10, Instructions: Tightening the loops**

**Type: A**

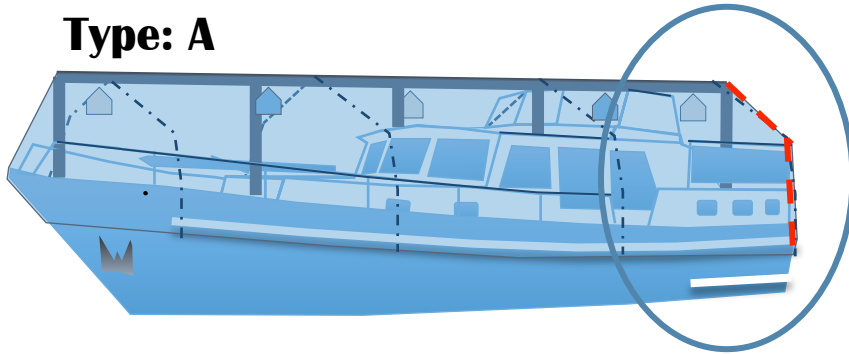

The boat cover will either fall over the railing or before the railing at the rear of the boat.

Type A: The cover falls over the railing, continue to page 15 **(skip page 16)**.

Type B: The cover doesn't fall over the railing, continue to page 16 **(skip page 15)**.

**Type: B**

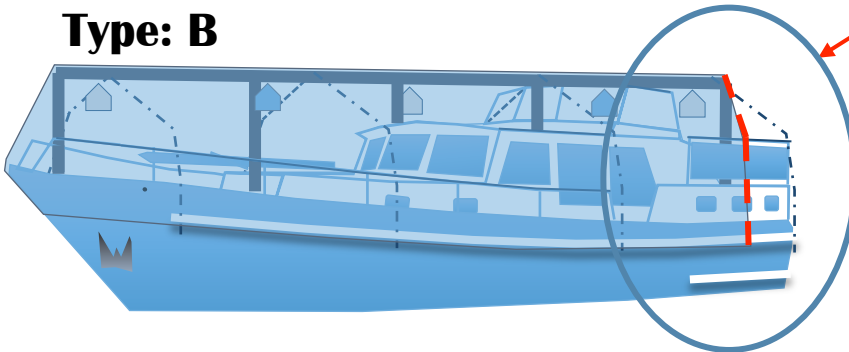



# Tailoring the backside, Type A

Segment A, falls over the railing

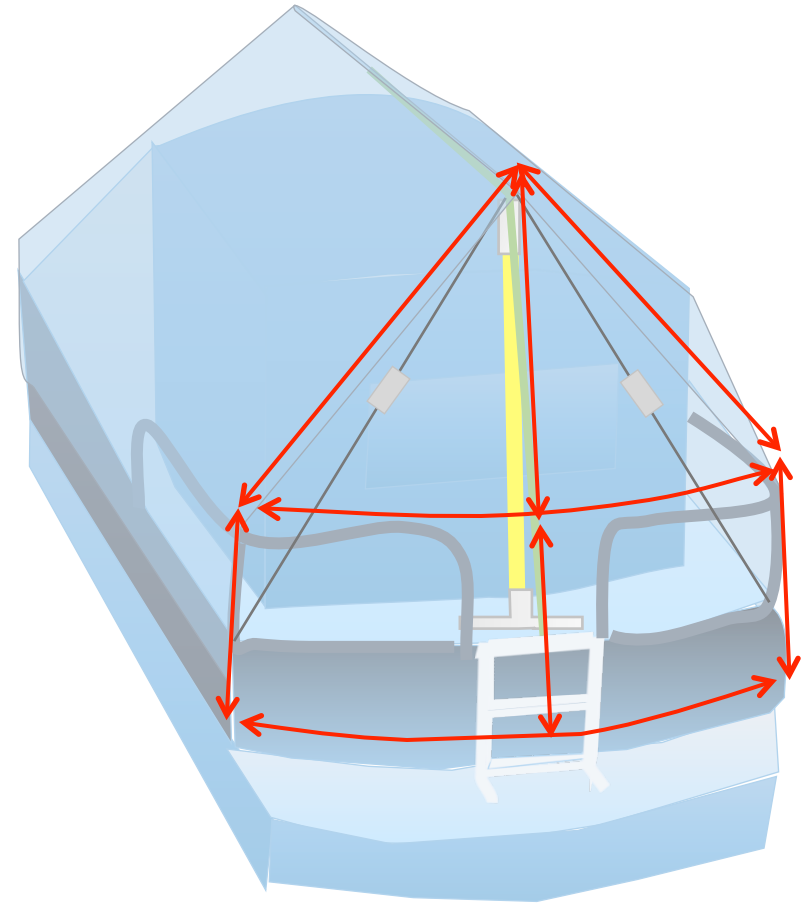
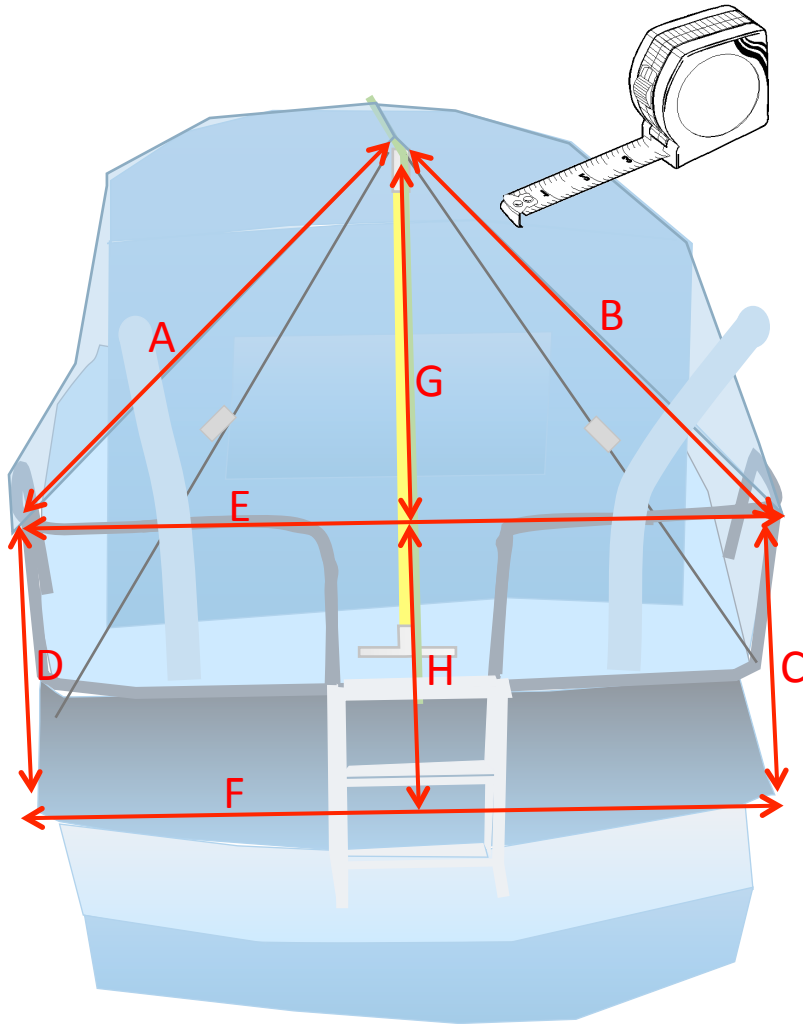



# Tailoring the backside, Type B

Segment B, doesn't fall over the railing.

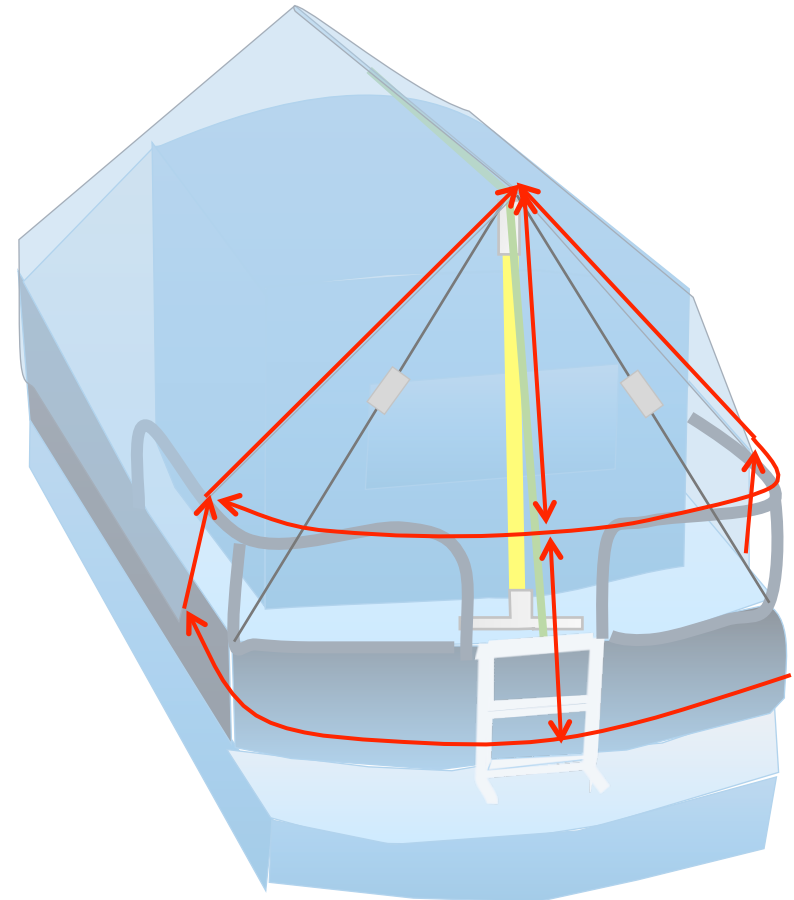
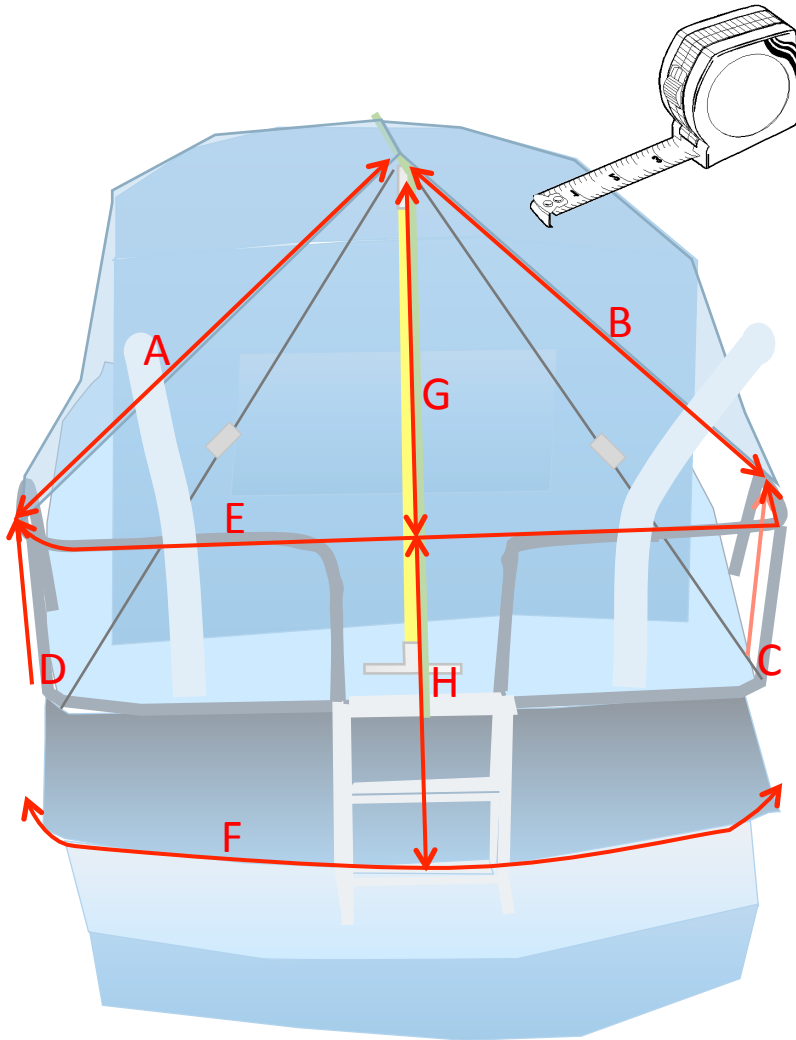





# Tailoring the backside



Segment (C) is needed for this step

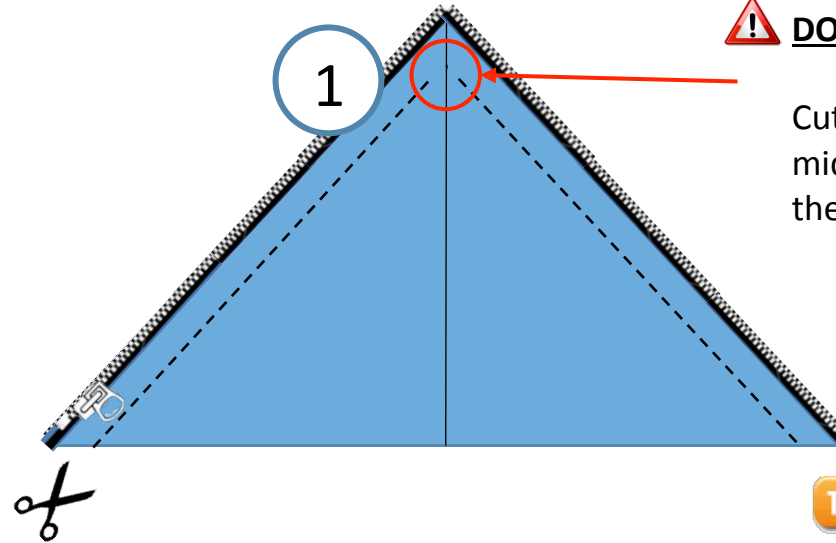

**DO NOT CUT ALL THE WAY!**

Cut the fabric to  $\pm 5$ cm from the middle on both sides. This way they will remain attached.



Fold the segment in half to determine the middle.

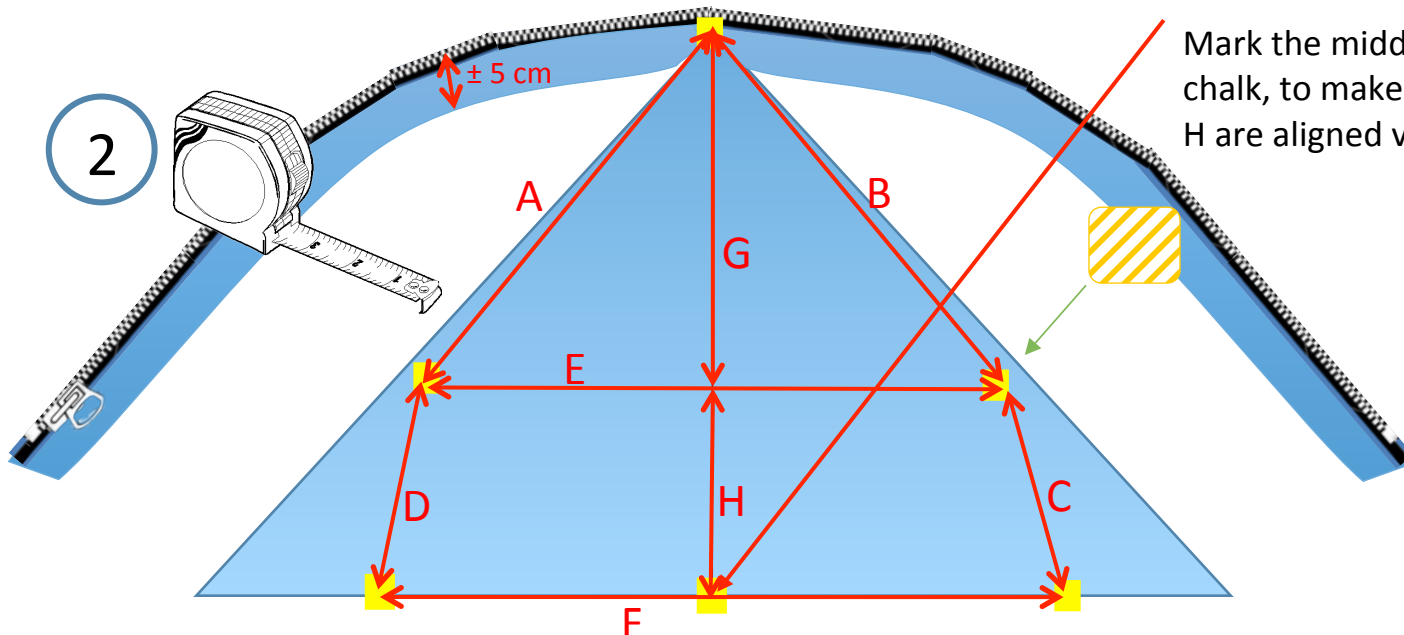

Mark the middle with the chalk, to make sure that G and H are aligned vertically.



# Tailoring the backside

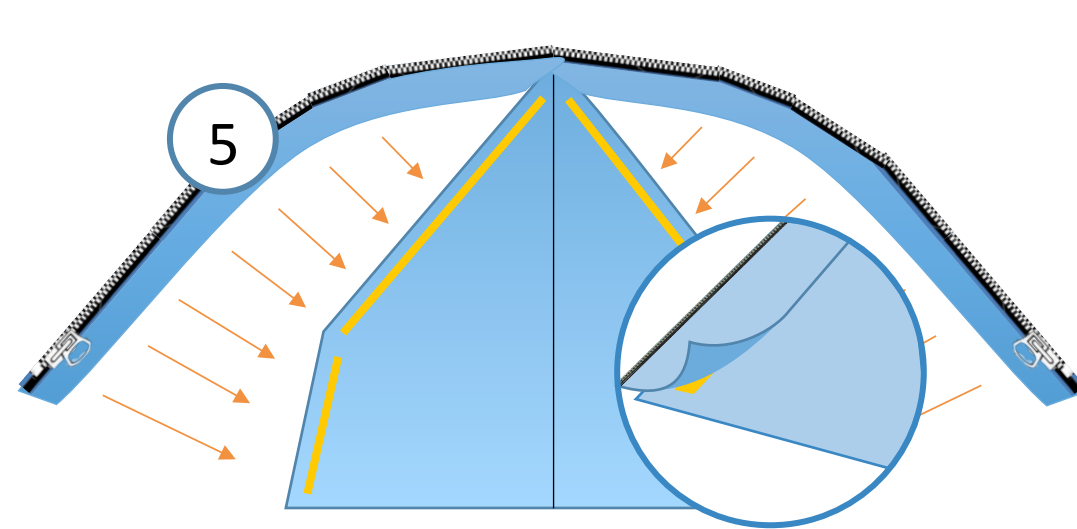
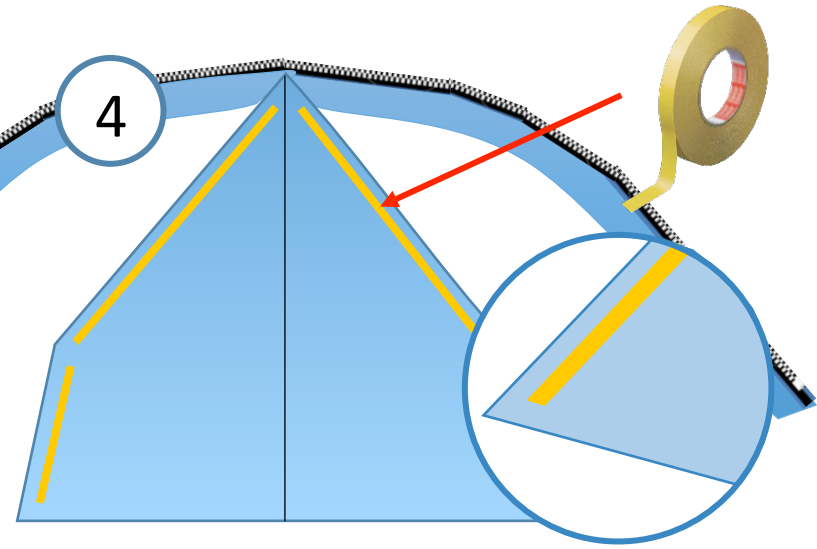
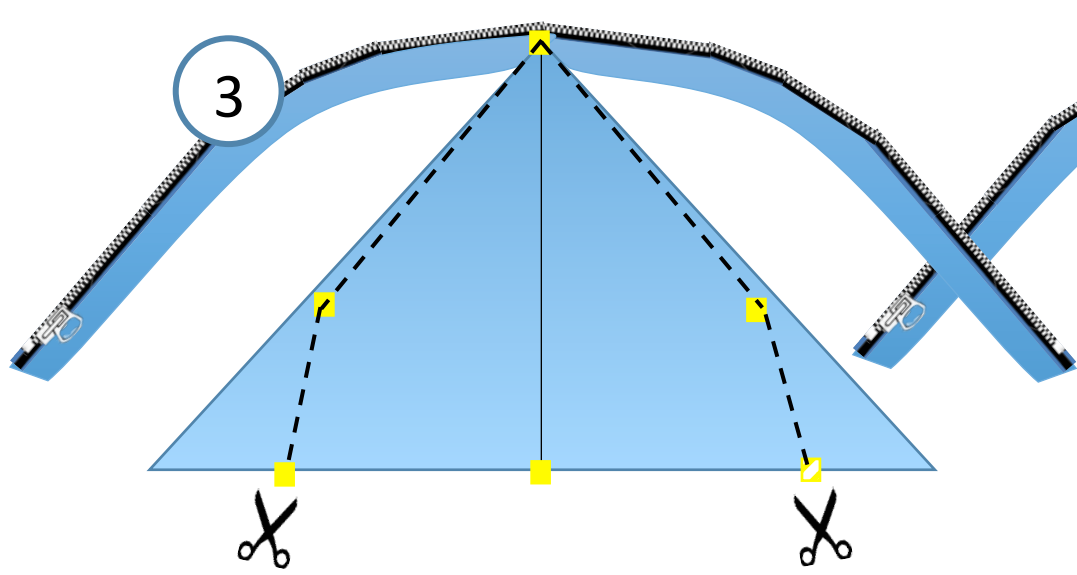

Secure the zipper along the edges

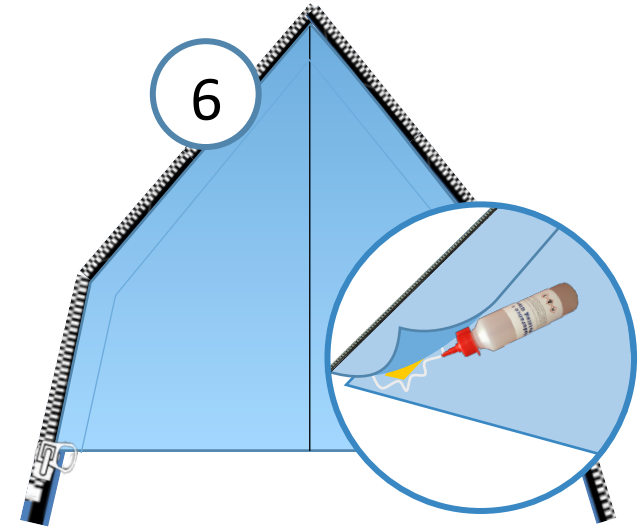

Weld the zippers along the double-sided tape



# Tailoring the backside (Davits)



**Skip this step if you dont have a Davits**



Carefully read the glue instructions!

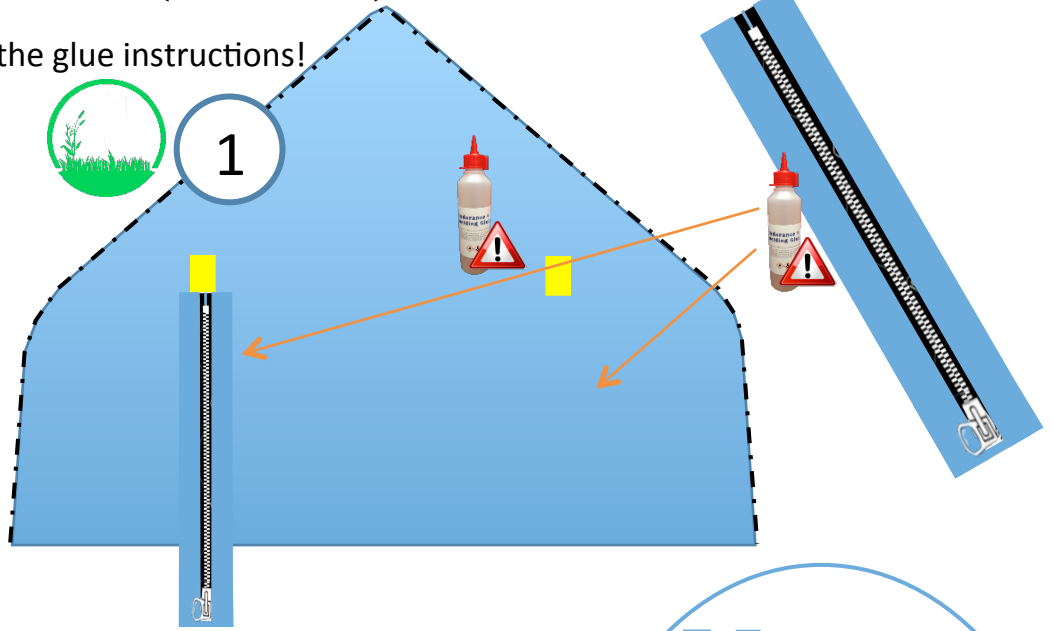
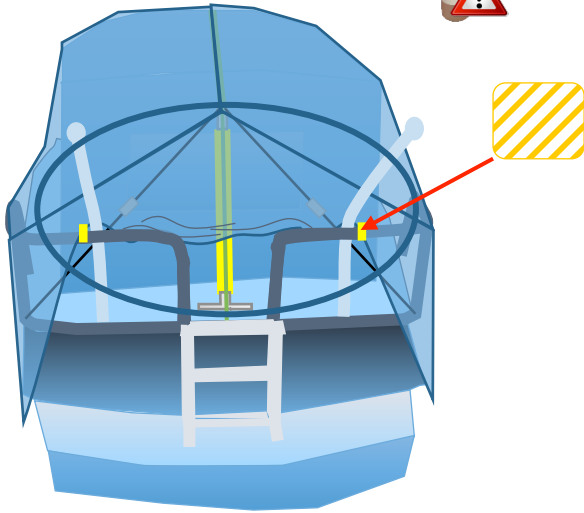

2

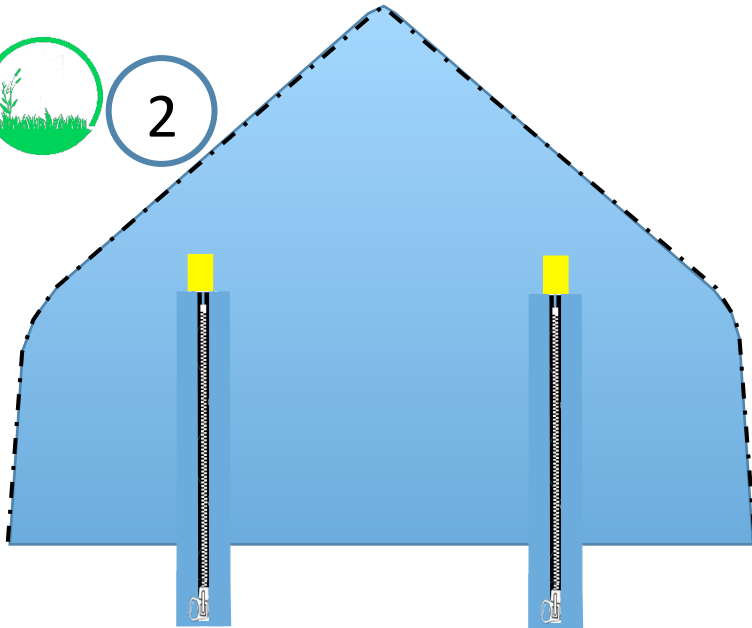

3

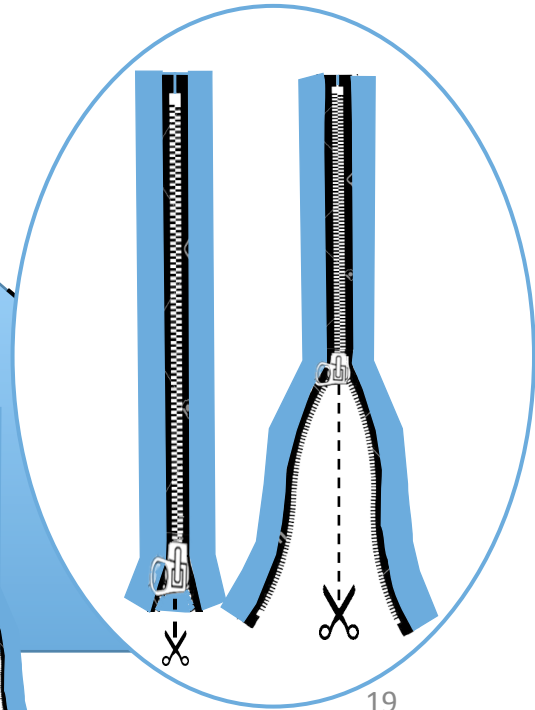
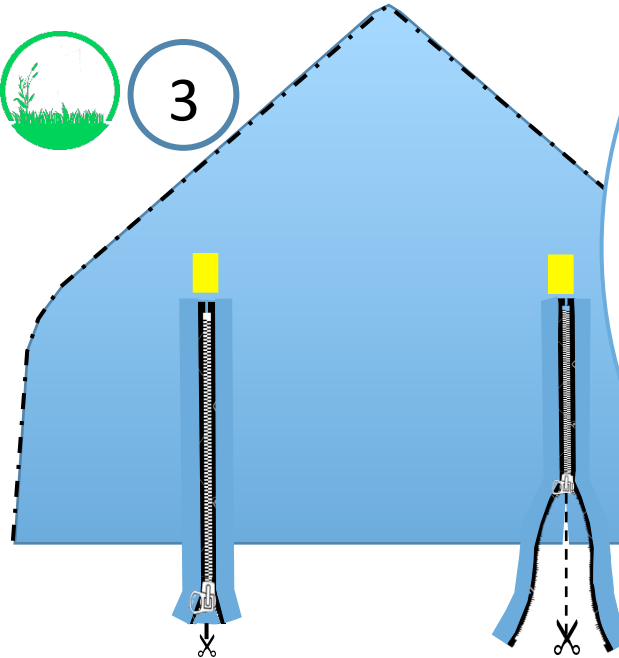

# Tailoring the backside (Davits)

 **Skip this step if you don't have a Davits**

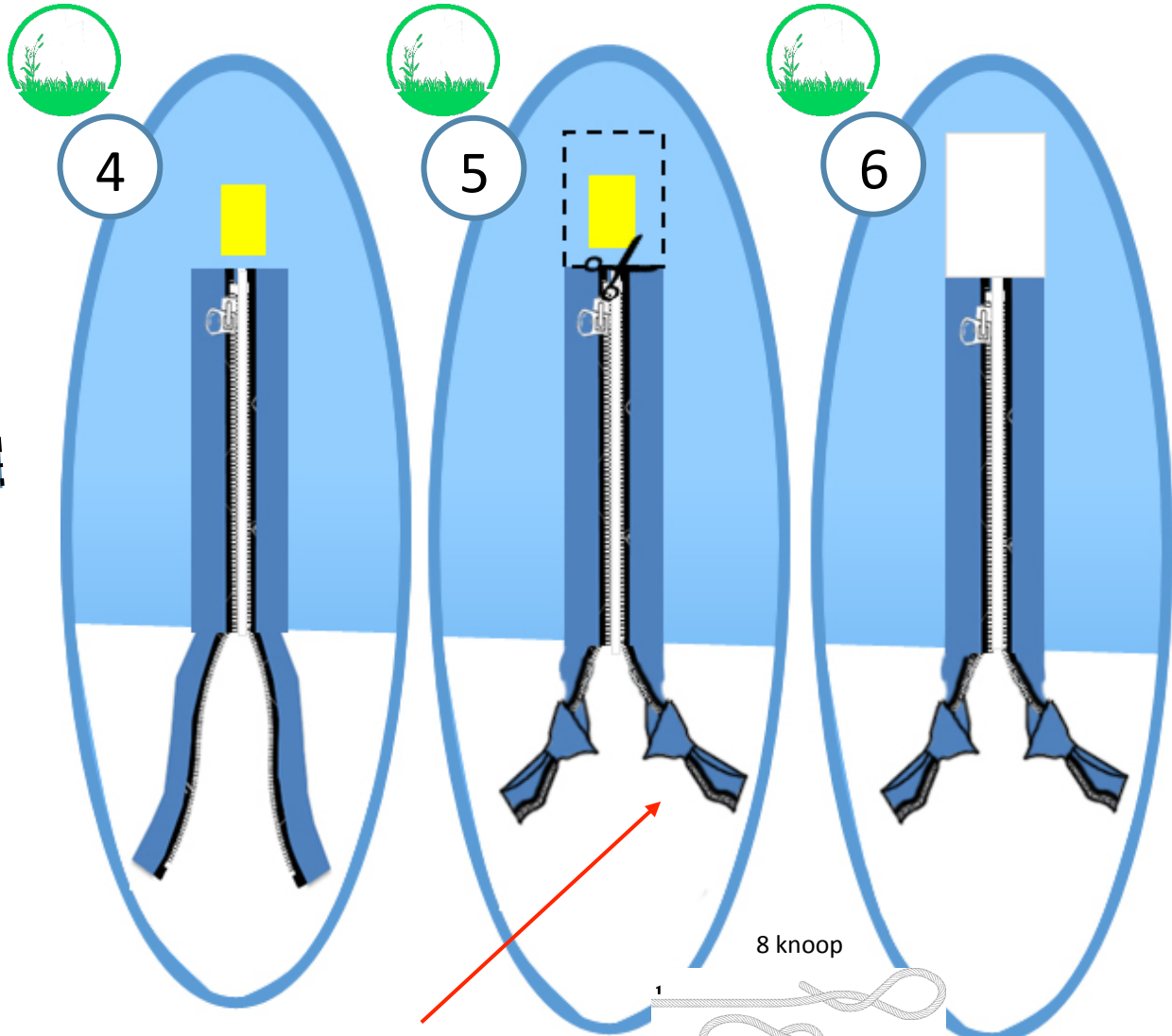
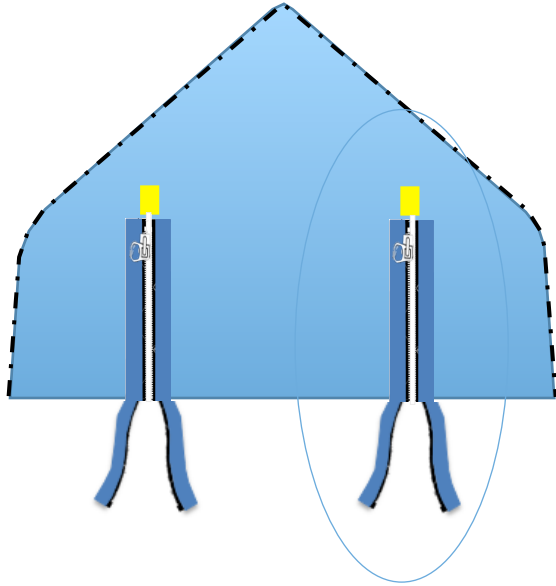

Knot the zippers tightly

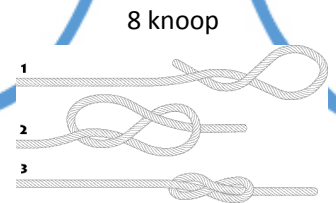



# Tightening the loops

Secure the cover to the boat, using the remaining shock absorption cords

**i** See page 10, Instructions: Tightening the loops

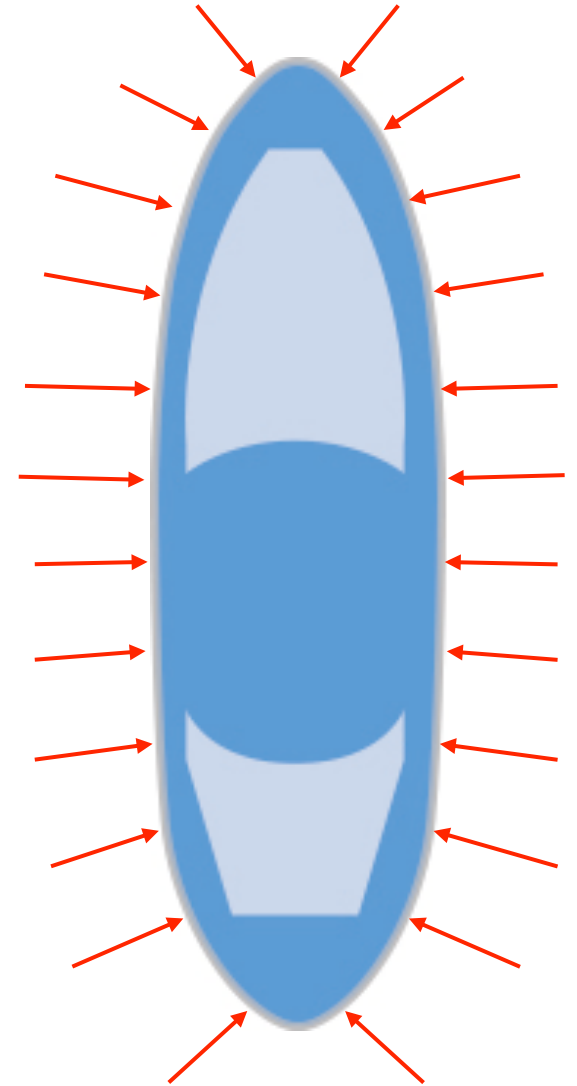
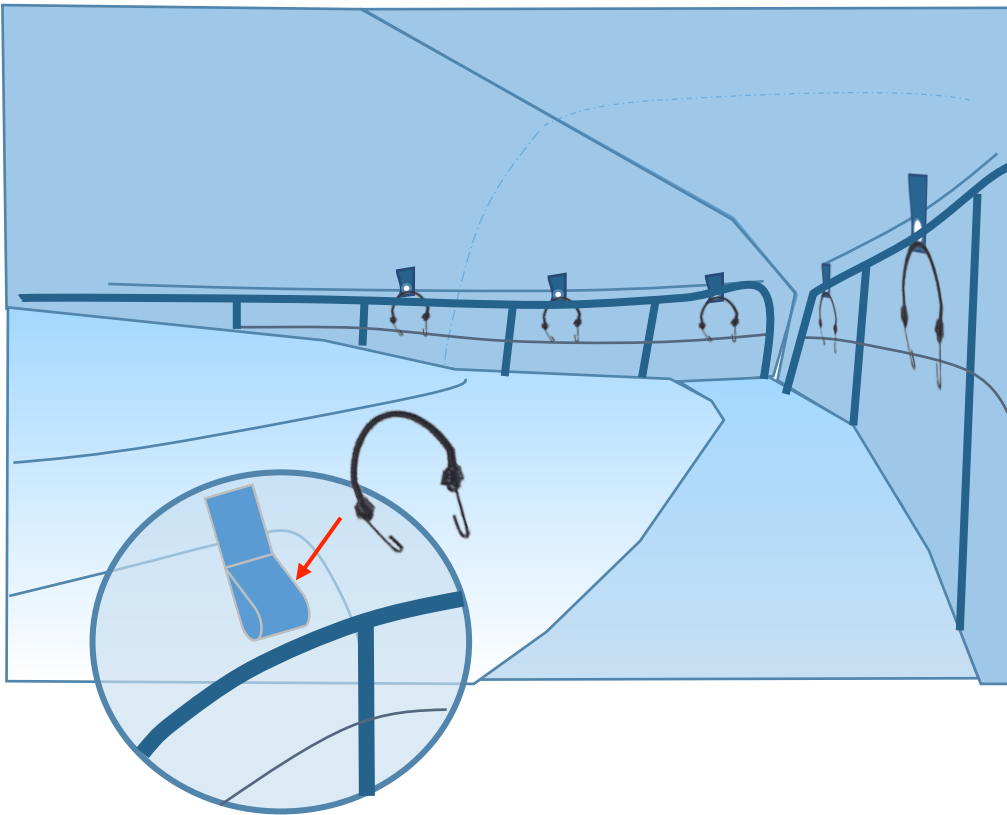



# Tailoring the frontside



Mark a **Λ** shape with chalk at the front end of the cover. Keep in mind, the 2 sides should almost touch when the cover has been cut.



1

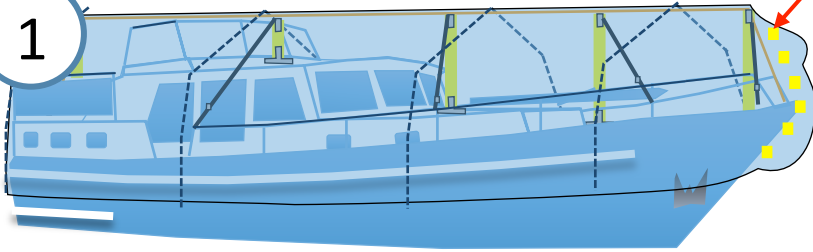

2

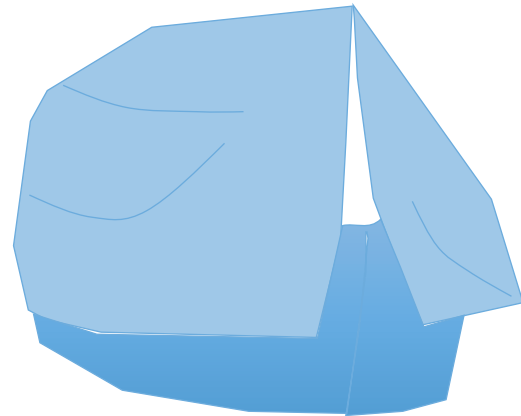
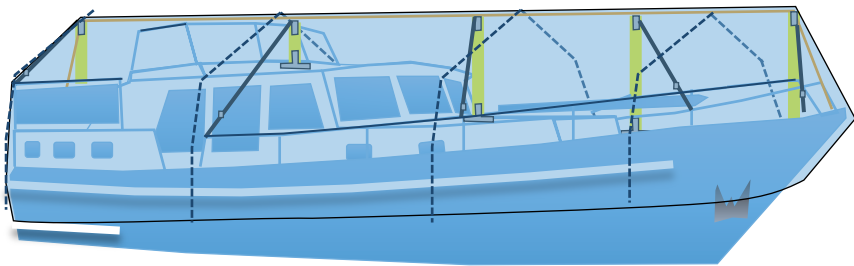
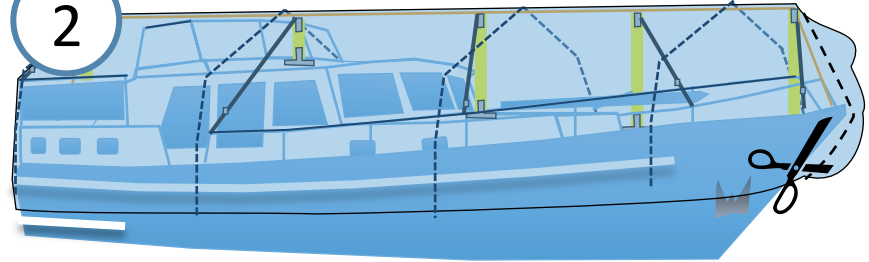

## Tailoring the frontside



1

Make sure the front is easy accessible. We advise you to perform this action from land.

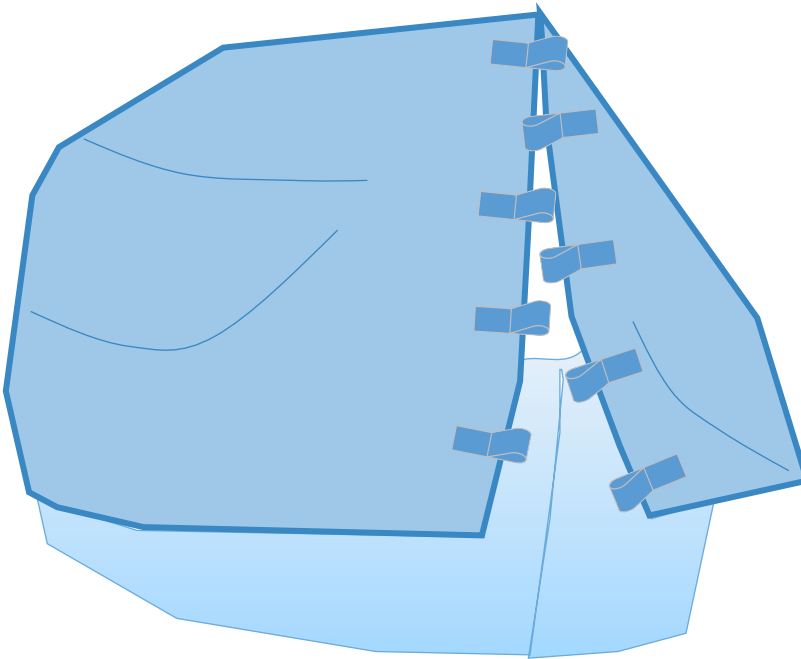

Carefully read the glue instructions!

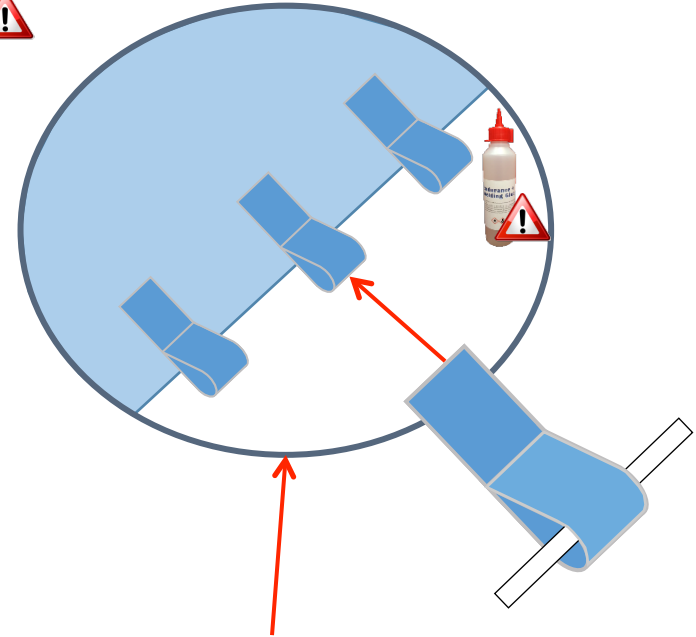

The loops should fall  $\pm 2\text{cm}$  over the edge of the cover.



Place the loops as seen in the image. This way they interlock when the cord is under tension.

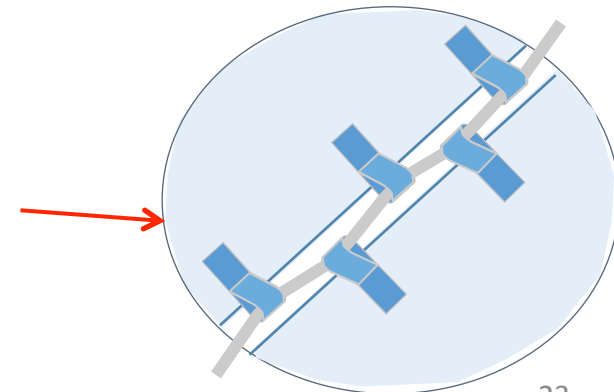

# Tailoring the frontside

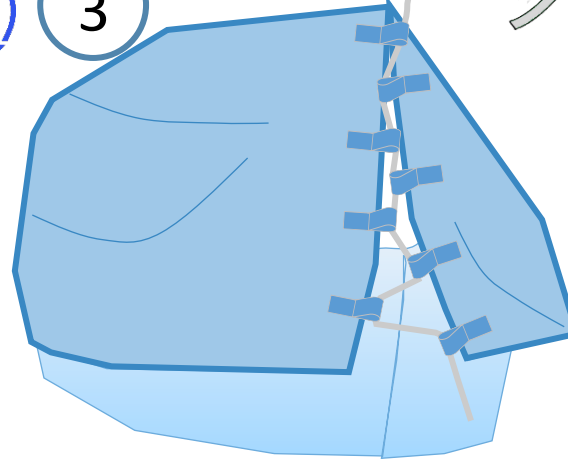
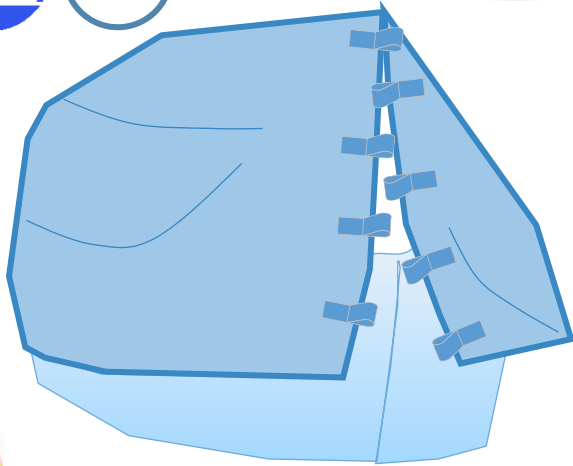

When you cut the elastic rope, use the lighter to melt the tip.

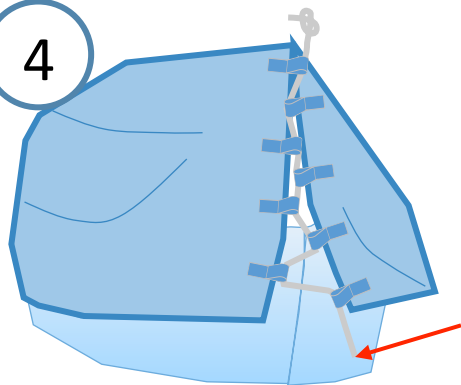

Tie a loop at the bottom side of the elastic. This loop can be spun around an anchor if possible.

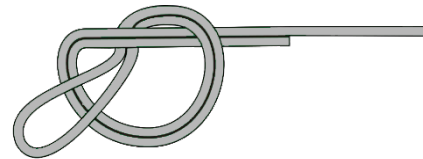

Close the front by lacing the elastic rope through the loops and put lots of tension on it. This will benefit the ventilation greatly.





# Placing mooring slots



Mark the moorings

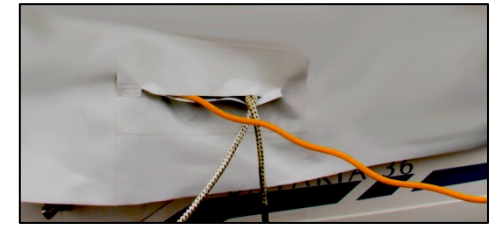
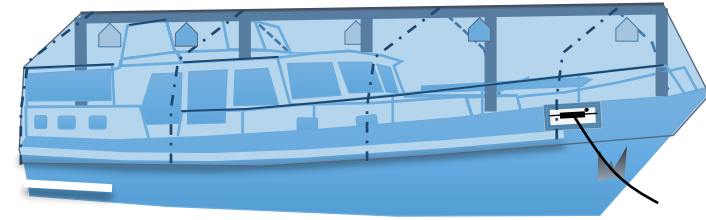
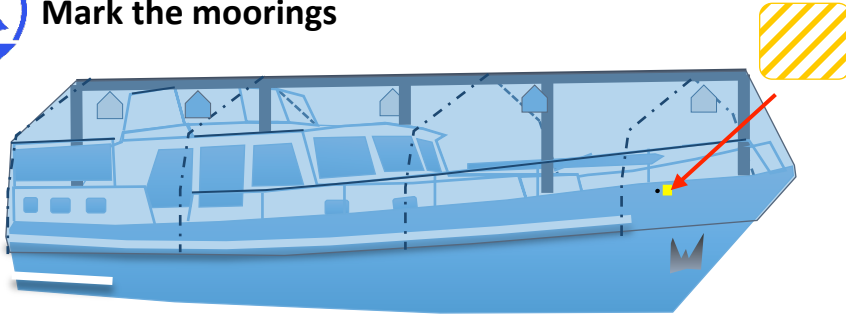

Weld / glue the moorings in place

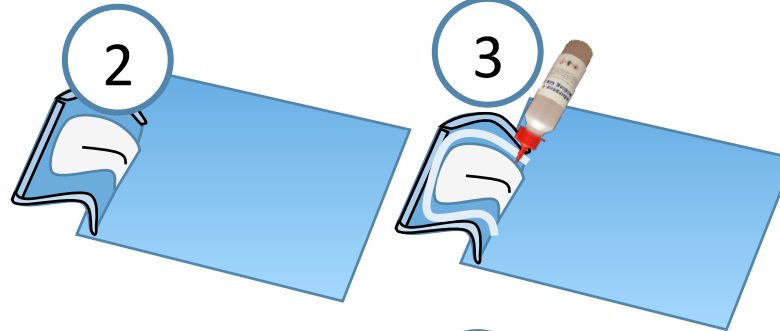
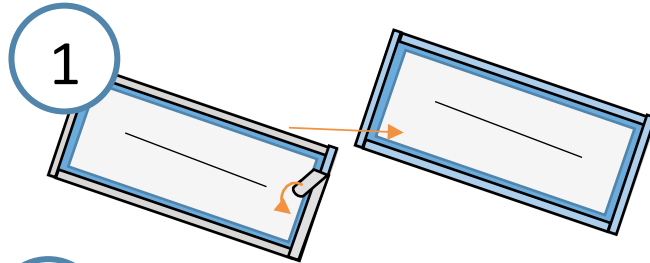

 Only put glue on the edges of the tape

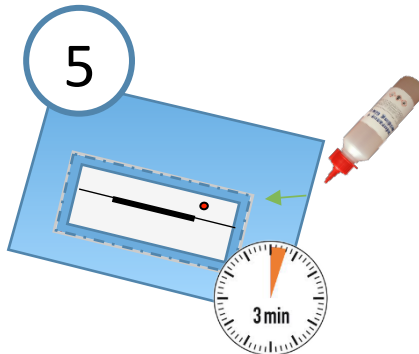
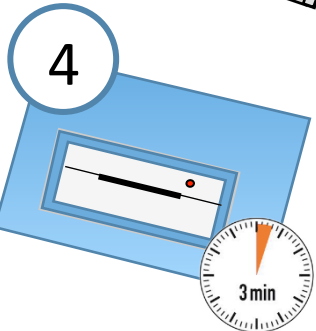

 Cut an oval shape in the cover. **Do not cut into the flap of the mooring**, this may cause unwanted leakage.

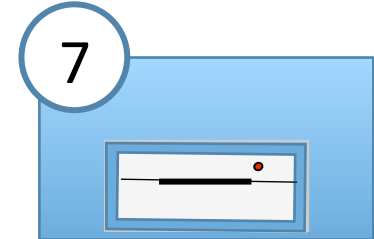
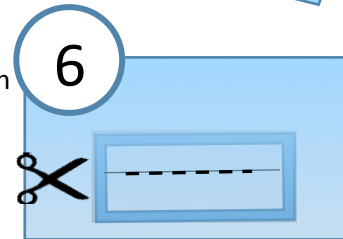

**TIP** If the cover sits perfectly in the middle of the boat, only mark 1 side. Take the cover from the boat, fold it in half and cut the cover at ones. This may save allot of time!

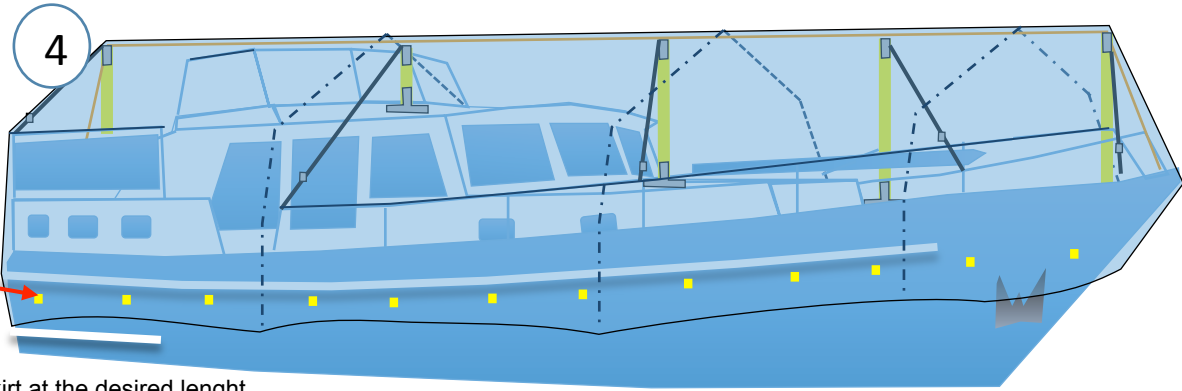

You can mark the skirt at the desired length.  
We advice you to let it fall for ± 30cm over the fenders.

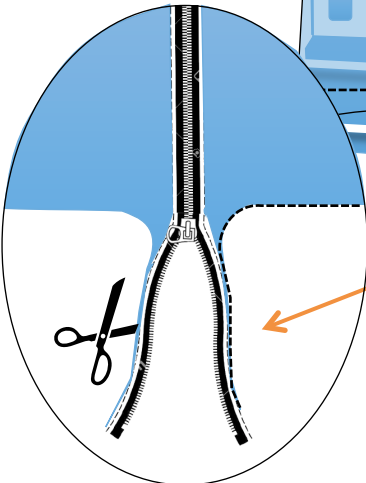
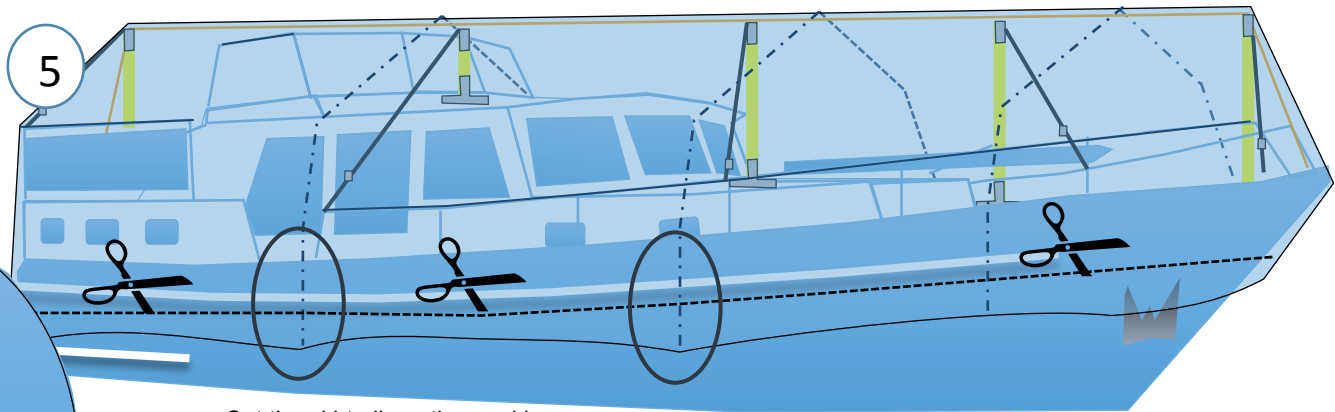

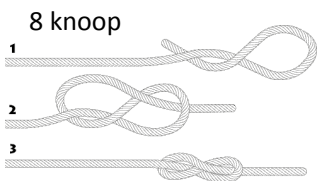

Cut the skirt along the markings.  
Leave a little strip along the zippers.  
Tie the zippers in a knot so you can cut / shorten them to the desired length.

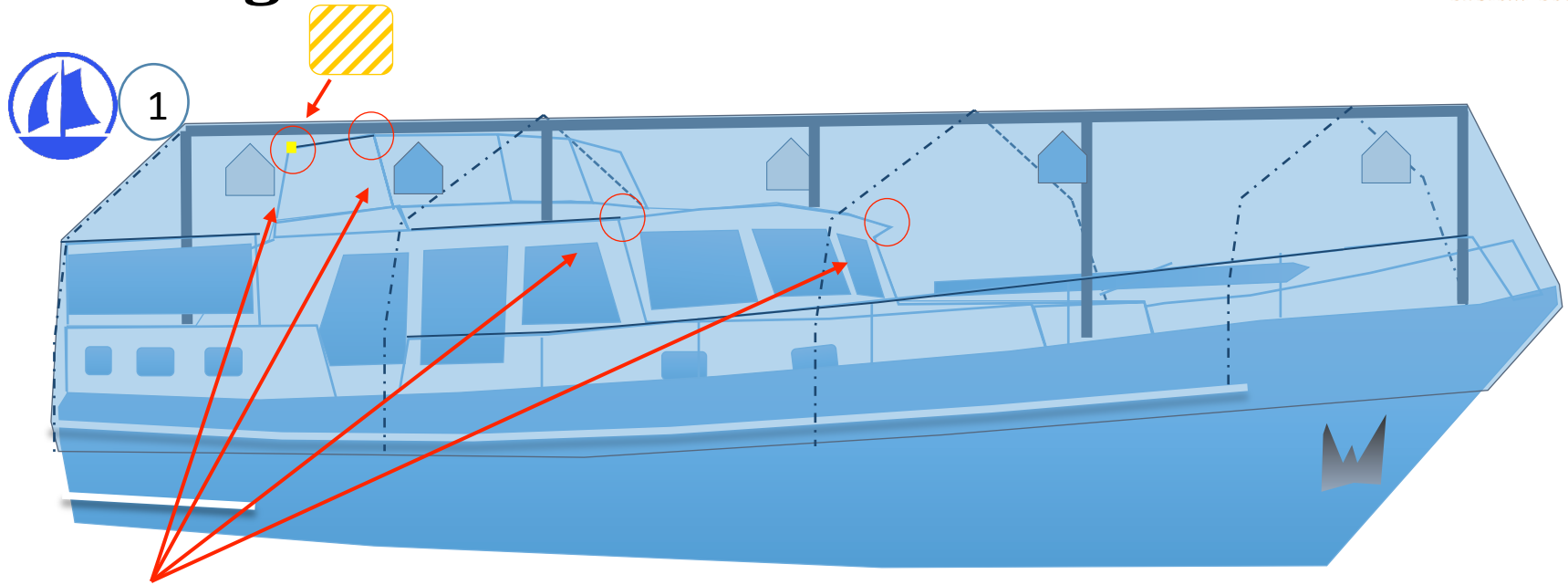

**TIP** Use the scissor as a knife?  
 Max 20mm  
 Cut with the scissor almost closed!

# Strengthen the boat cover



 Apply the strengthening pads on the inside, where the cover is in contact with the boat.



Carefully read the glue instructions!

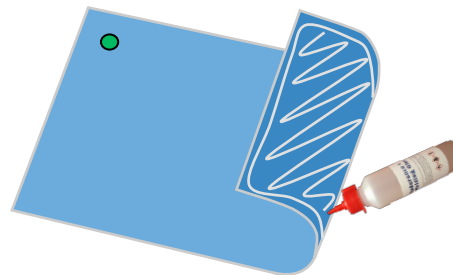



# Spanfix, Boat remains in the water

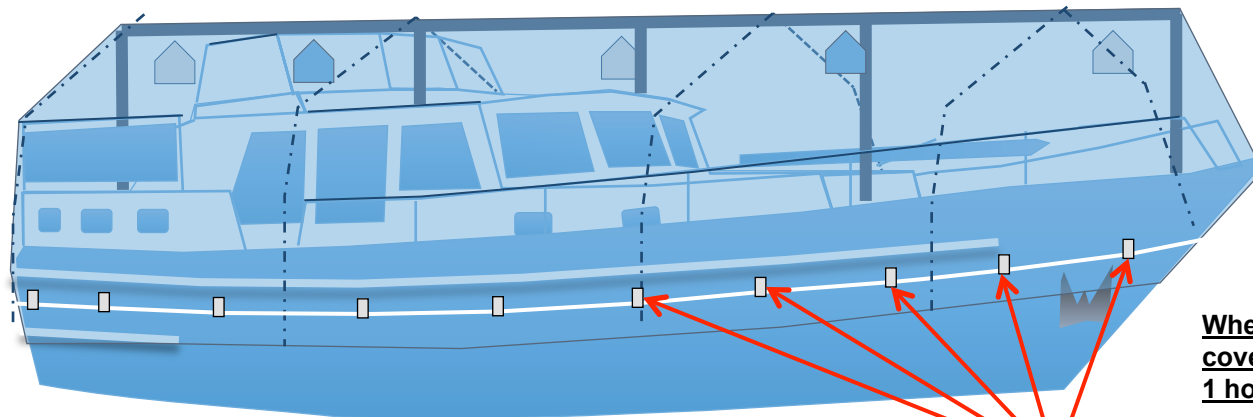

**When the loops are welded to the cover, let them dry for at least 1 hour before lacing the rope.**

**i** The loops share the function of a belt. The rope is laced through the loops, after which it is tensioned. This will cause the skirt of the cover to remain clamped against the side of the boat and still provide good ventilation.

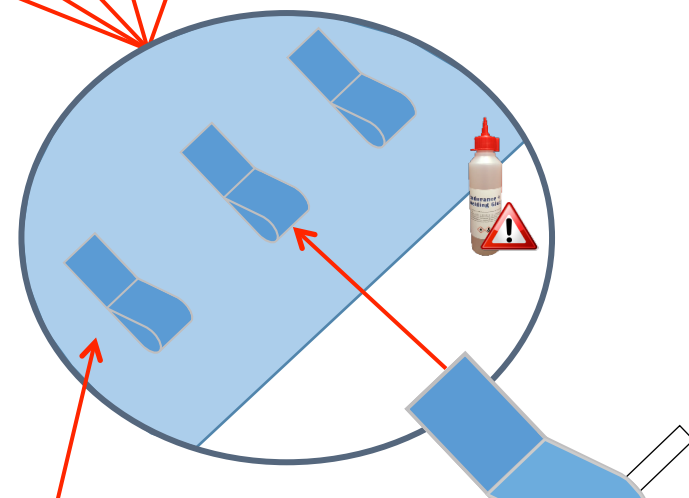

Place the loops at roughly 25 to 30cm from the bottom of the cover.



Carefully read the glue instructions!



# Option: Spanfix, Boat for storage on land

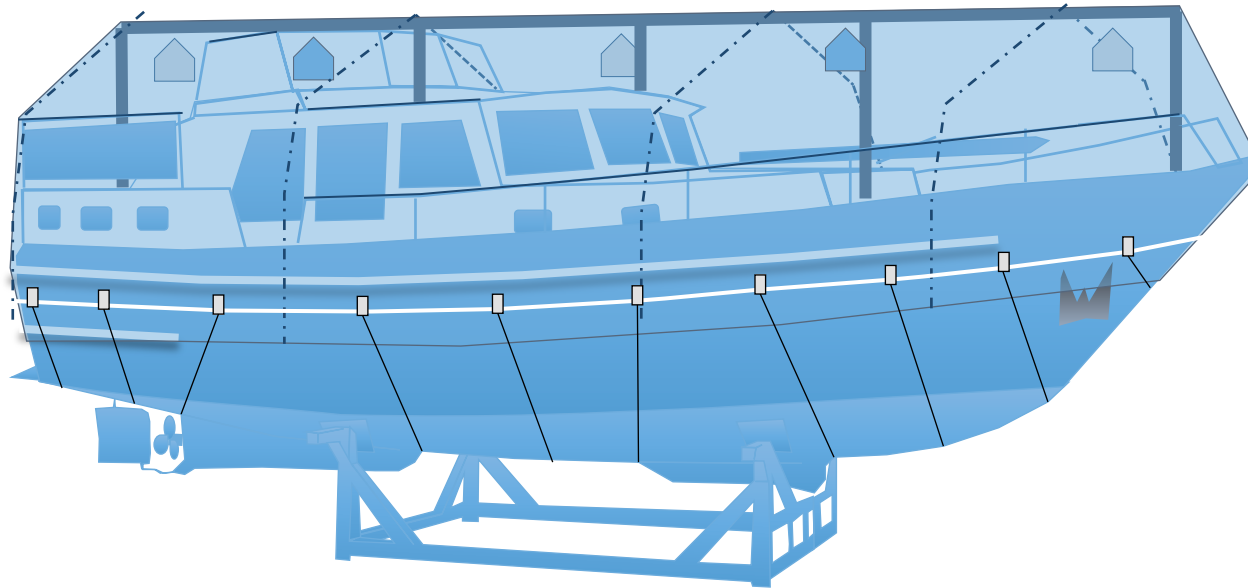

Besides the use of the Spanfix, you can also secure the cover by tying extra ropes together underneath the boat. You can use the same loops as the ones used for the Spanfix.



# Mounting the cover after 1st installation

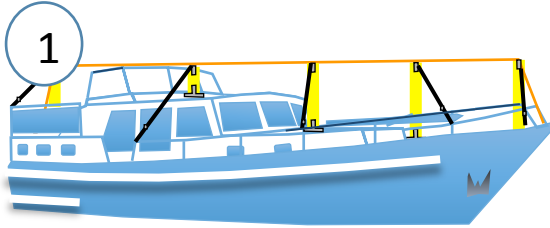

Setting up the frame

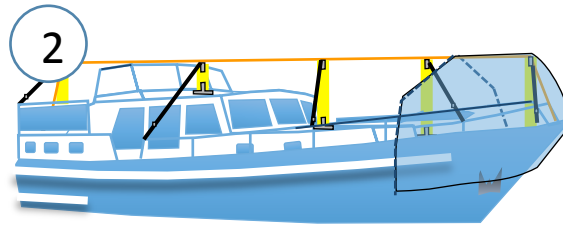

Placing the segments

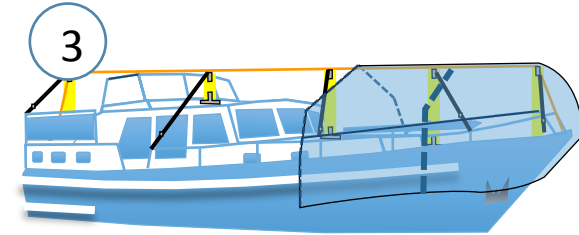

Placing the segments

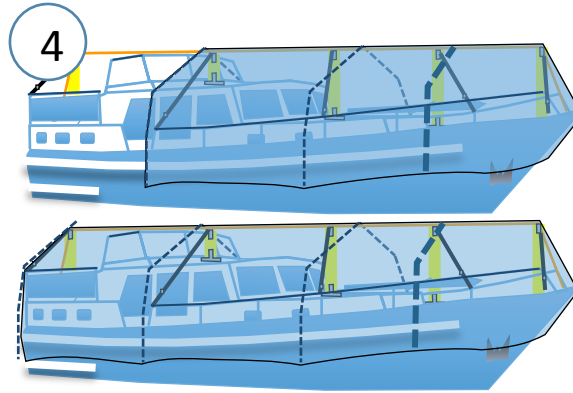

Placing the segments

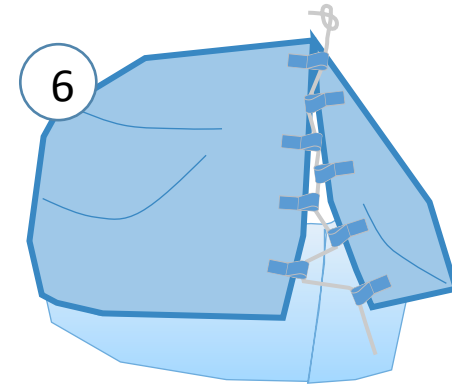

Lacing the front

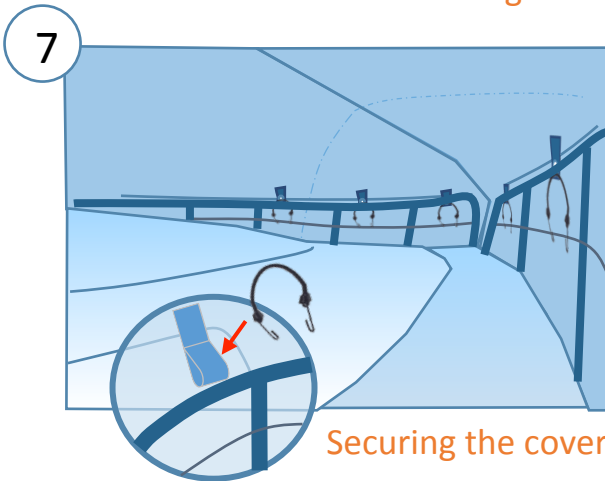

Securing the cover

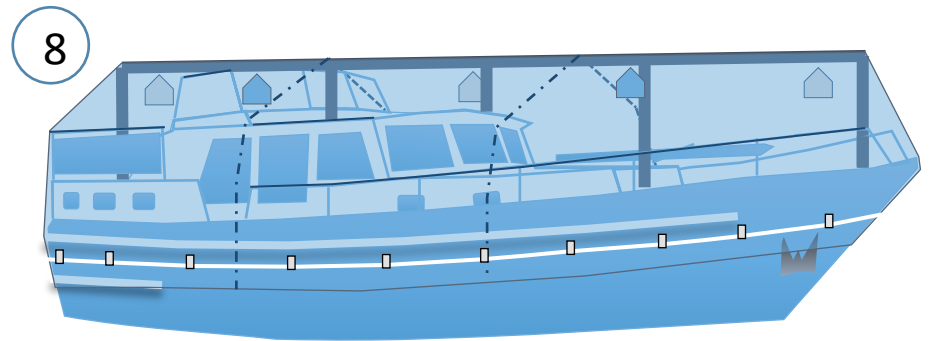

Tensioning the Spanfix

# Tips



## Springtime Service!

We would love to see you back for the Springtime Service! This can be done right before you will start to set sail, to explore the deep blue world we call home.

### Tip 1

An extra hand will make the job allot easier, faster and more fun!

### Tip 2

Secure the frame firmly onto the boat, this is the foundation of the cover. We advise the use of our Hurricane frame.

### Tip 3

Put allot of tension on the loops on the inside of the cover. Only put tension in the direction of the loops.

### Tip 4

Work your way from the front of the boat to the back, and check in between if all goes well from the outside. This way you can spot problems early on and ensure an optimal result.

### Tip 5

The cover can handle snow with ease. As a precaution, we advise you to remove large amounts of snow. This can easily be done from the inside of the cover.

### Tip 6

We provide a Bootzeil maintenance service. This covers scratch marks and other adjustments.

### Tip 7

It's alright if the cover has folds in them, as long as they don't accumulate water puddles.

## **Algemeen**

Het dekzeil Pampus is een semi-maatproduct, er zullen altijd wat plooien blijven hier en daar. Bootzeil heeft een service werkplaats wij kunnen altijd nog aanpassingen voor u doen. Ook ritsen kunnen er nadien nog ingezet worden als u wilt.

## **Het zeil is te smal/past niet**

Bel ons op, wij kunnen u van tips voorzien om het zeil er beter op te krijgen dankzij onze ervaringen. Indien nodig vragen wij u een paar foto's te sturen.

## **Het zeil is te kort**

Zet het zeil aan de achterzijde vast en trek aan de voorzijde zo hard als u kan aan het zeil. Indien u meer dan 10 cm te kort komt dan is het raadzaam even contact met ons op te nemen en ons een paar foto's te sturen. Wij helpen u dan verder. Indien nodig komen wij langs.

## **Het zeil valt niet over de stootrand**

Het kan lijken alsof het zeil niet over de stootrand gaat. Vaak komt het zeil beter uit nadat u de lusjes heeft bevestigd aan de railing. Indien het zeil nog te smal is dan is het vaak met een kleine aanpassing aan het frame te verhelpen. Wanneer u 5 cm tekort komt dan kunt u het frame 7,5 cm in korten.

## **Ik wil het zeil laten installeren**

Bootzeil werkt met een groep installateurs met veel ervaring. Ze werken door het gehele land, vaak ook in het weekend. Gemiddeld kost een installatie ca. 550 euro afhankelijk van het aantal uren werk en de reistijd. De installateurs kunnen ook aanpassingen opmeten en deze op een juiste, zorgvuldige wijze doorgeven aan onze werkplaats. Bel 023 – 521 96 92 en maak direct een afspraak.

## **Ik zie af en toe een paar stikfoutjes**

Bootzeil laat haar dekzeilen met de hand maken door geschoolde vakmensen die een bijna perfect product afleveren. Het blijft echter handwerk. Dus een foutje zit er af en toe in. Een schadelijk foutje repareren we graag tijdens de lenteservicebeurt. (gratis tijdens de lenteservicebeurt)

## **De stiknaden voelen vochtig aan**

De eerste maanden kunnen de stiknaden vocht absorberen, Dit komt omdat zij in een industriële omgeving gemaakt en verwerkt zijn. Doordat het weer er in gaat zitten verstoppen de poriën en sluiten de stiknaden zich in de loop der tijd vanzelf waterdicht af. U kunt dit proces versnellen met waterstopspray.

**Is uw vraag niet beantwoord, bel ons dan even op, wij helpen u dan graag verder: 023 - 521 96 92**



## Bootzeil also makes covers for garden furniture and more

